



M/S. MAJID BUKATARA BLDG. MTRLS. TRDG. LLC

P.O. BOX 50897, DUBAI-U.A.E. TEL: 04-3371710 FAX:04-3371999

E-MAIL: mbbmdxb@mbbm.ae

Fire Rated Steel Doors and Rolling Shutters

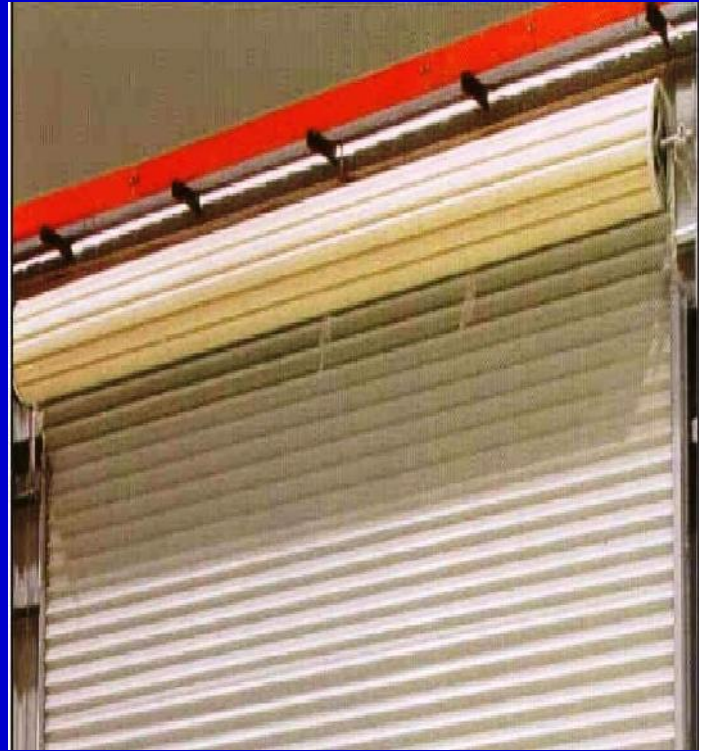

COMPANY PROFILE

Manufacturers:

- C.M.Juan Grases(Spain)
- Advance Metal Industries Factory L.L.C-Ajman(U.A.E)
- Ferco Shutters & Seating System L.L.C-Dubai(U.A.E)

TABLE OF CONTENTS

<i>Section</i>	<i>Description</i>	<i>Remarks</i>
01	INTRODUCTION	ENCLOSED
02	TRADE LICENSE	ENCLOSED
03	LIST OF PRODUCTS	ENCLOSED
04	PROJECT LIST	ENCLOSED
05	COMPANY LISTINGS	ENCLOSED
06	PRODUCT CATALOGUES	ENCLOSED
07	LOCATION MAP	ENCLOSED

INTRODUCTION

Company Profile

MBBM GROUP

The MBBM group's foundation was laid in Dubai by its parent company "Majid Bukatara Building Materials LLC" in 1984.

The MBBM group is a very well known name as a supplier, major manufacturer and fabricator of products as well as services related to the construction industry in U.A.E.

The group's business is based on timely delivery, commitment to quality and the highest standard of customer care & satisfaction followed by after sales service. The group's reputation and credit worthiness in the industry continues due to its unique vision, entrepreneurial skills and commitment to quality and adherence to customer specification.

Core Strengths

Trading: Building Materials, Plumbing, Electrical, HVAC and Metal Doors including Rolling Shutters, Industrial Doors & Sliding Doors (Distributorship of prestigious brands from U.S.A, U.K, France, Germany, India, Spain & China)

Subsidiary:

Grit Blasting and Epoxy coating facilities for steel manhole cover for Dubai municipality projects.

Special Fabrication in UPVC: Green Traps,

Manufacturing (Stainless Steel Division):

Waste Management System

Stainless Steel Customized Products

Glass Reinforced Plastic Products

Company Profile

MBBM GROUP

Fabrication:

GRP

Glass reinforced products: Manhole sealing plates and special fabrication

Wrought Iron Decorative Products

Group turnover:

AED350 million.

Infrastructure: Work-force of 250 dedicated, skilled and technically qualified professionals, supported by modern offices.

Factory in JAFZA for stainless steel fabrications.

Factory in DIP for garbage chute fabrications.

Warehouse in Ras-Al-Khaimah, Al Ramool and Rashidiya in Dubai.

Offices in Dubai, Sharjah and Abu Dhabi.

Bankers:

M/s. United Arab Bank,

P.O. Box 4579, Deira, Dubai, UAE

M/s. Bank of Baroda,

P.O. Box 5107, Deira, Dubai, UAE

M/s. Habib Bank AG Zurich,

P.O. Box 3306, Deira, Dubai, UAE

Goal&Mission:

To be the preferred supplier for the construction industry in the segments which we address. Adapting to change and moving ahead with honesty, integrity & commitment to the customer's satisfaction through innovative and committed practices.

TRADE LICENSE

4 /D/181

رقم الترخيص :



دولة الإمارات العربية المتحدة

وزارة الداخلية

الإدارة العامة للدفاع المدني

إدارة الحماية المدنية و السلامة

ترخيص مصنع

تم ترخيص المصنع لصناعة المواد المبينة استناداً إلى القانون الاتحادي رقم ٣ لسنة ١٩٧٩ بشأن الدفاع المدني وتعديلاته والقرارات الوزارية المنفذة له .

الإسم التجاري للمنشأة:

أدفانس للصناعات المعدنية/ذ.م.م.

الجنسية

الإمارات

حسين خلفان الشامسي

حسين

اسم صاحب الترخيص :

الجنسية

الهند

منور خان وهاب

منور

اسم صاحب الترخيص :

تاريخ بداية المنشأة :

2010/10/24

تاريخ بداية المنشأة :

أبواب مقاومة للحريق.

نوع النشاط :

الهاتف :

06/7434007

الجرف :

الشارع :

صناعية

المدنية

عجمان

الإمارة :

منطقة النشاط :

تاريخ الانتهاء :

2012/10/22

تاريخ الانتهاء :

2012/1/22

تاريخ الإصدار :

..... (//) إلى (1)

(1)

(//)

المعدات و الأجهزة والمواد المرخص بتصنيعها من رقم :

مدير عام الدفاع المدني

مدير إدارة الحماية المدنية



التاريخ م: 19-03-2012
الموافق هـ: 26-04-1433
درجة التنفيذ: عادي
المرجع: قديم / 5-17/1/4204/01/1123

السادة/ دائرة التنمية الاقتصادية المحترمين

السلام عليكم ورحمة الله وبركاته

الموضوع : تراخيص معدات الدفاع المدني

تقدم إلينا السادة : ادفانس للصناعات المعدنية ذ م م فرع

المالك / السيد : حسين خلفان عبدالله الشامسي

رقم الترخيص : رخصة جديدة.

نوع الرخصة : رخصة صناعية

نوع المعاملة : استخراج رخصة.

وضع الشركة : شركة غير مرخصة.

بطلب ما يلي :

اسم النشاط	رمز النشاط التابع للدائرة الاقتصادية
1 استخراج رخصة صناعية صناعة الابواب المعدنية المقاومة للحريق	281118

لا مانع لدينا من الموافقة المبدئية على أن يراجعونا عند استلامهم للرخصة التجارية حسب نوع المعاملة وذلك لاستكمال إجراءات ا
الرسمي بالنشاط المذكور اعلاه في مدة اقصاها شهر من تاريخ استلام الرخصة التجارية.

ملاحظة: عدم مزاولة النشاط لحين اصدار الترخيص الرسمي الخاص بالشركة من قبل الادارة العامة للدفاع المدني-دبي



وتفضلوا بقبول فـ

نسخة الى:
المرفقات:

مدير إدارة السلامة الوقائية
الرائد/جمال أحمد إبراهيم



تجديد

رخصة صناعية

سجل تجاري رقم: 2187

فيد صناعي رقم (374)

رقم الملف: 11871

رقم الجواز

الحيثية

أسماء أصحاب الترخيص

الإمارات

إسم الشركة: ادفانس للصناعات المعدنية/ذات مسؤولية محدودة

الإسم التجاري: ادفانس للصناعات المعدنية /ذ.م.م

Trade Name: ADVANCE METAL INDUSTRIES /L.L.C

الشكل القانوني: شركة ذات مسؤولية محدودة

نوع النشاط: صناعة الأشغال المعدنية للمباني

1918674

الهند

إسم المدير: منور خان وهاب خان

المؤجر /منور خان وهاب خان

العنوان: صناعية الجرف

تاريخ إنتهاء العقد: 2012/12/31

شيرة رقم: 2

صندوق بريد: 9159

هاتف: 7488966

تاريخ الإصدار: 1989/07/29

تاريخ الإنتهاء: 2012/12/06

ع / مدير عام البلدية

LIST OF PRODUCTS

PRODUCT RANGE

- 1. FIRE RATED STEEL DOOR AND FRAMES**
- 2. NON-FIRE RATED STEEL DOOR AND FRAMES**
- 3. FIRE RATED STAINLESS STEEL DOOR AND FRAME**
- 4. ACOUSTIC FIRE RATED STEEL DOOR AND FRAMES**
- 5. WATER TIGHT STEEL DOOR AND FRAMES**
- 6. AIR TIGHT STEEL DOOR AND FRAMES**
- 7. X-RAY PROOF STEEL DOOR AND FRAMES**
- 8. BULLET PROOF STEEL DOOR AND FRAMES**
- 9. SECURITY STEEL DOOR AND FRAMES**
- 10. FIRE RATED ACCESS STEEL DOOR AND FRAMES**
- 11. SLIDING DOORS**
- 12. ROLLING SHUTTERS**
- 13. OVERHEAD SECTIONAL DOORS & GARAGE DOORS**

FIRE RATED STEEL DOOR AND FRAME

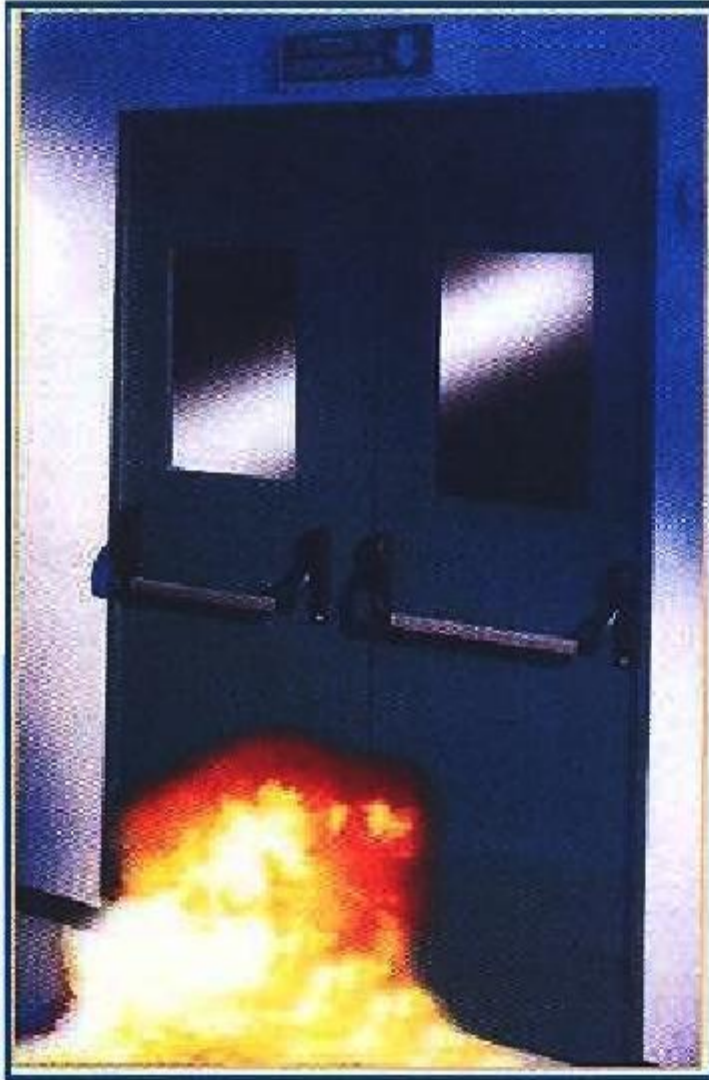

Fire rated steel doors and frames are designed to delay the transfer of heat from one side of the door to another. Full flush doors an interlocked hairline seams on vertical edges and have no visible seams on faces. Doors specified seamless have no visible seams on faces or vertical edges. Face sheets are totally supported by special core used to cover the entire door to delay the heat transfer from one side to another and to avoid burning of people during escape from fire. Top and bottom door edges are closed by 1.5mm inverted steel channel welded in place.



FIRE RATED STAINLESS STEEL DOOR AND FRAME

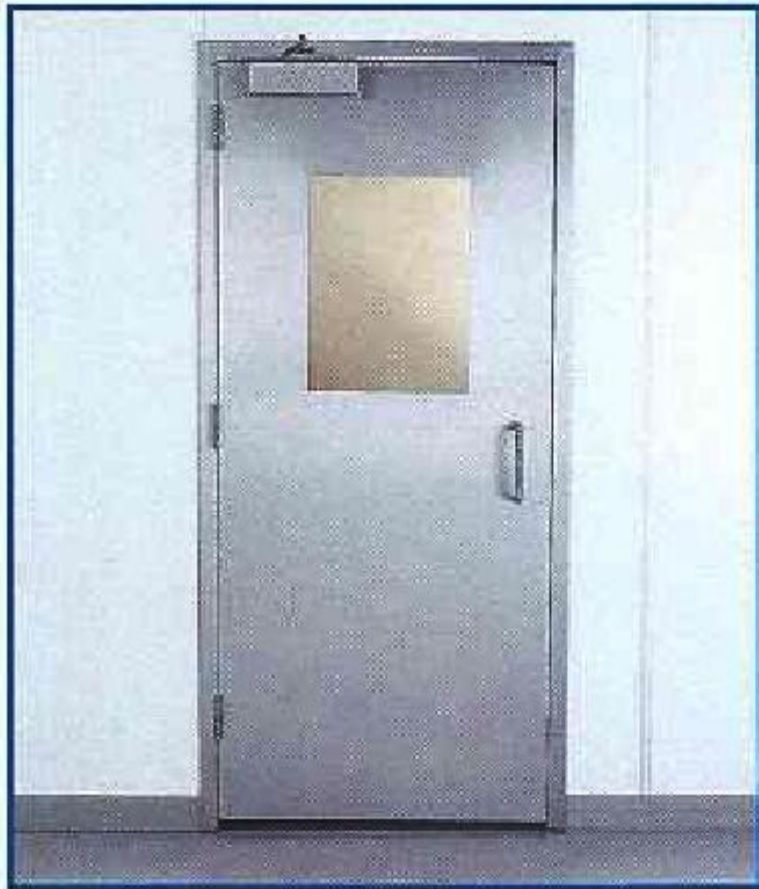

Fire rated stainless steel doors and frames are manufactured from stainless steel and designed to withstand severe weather conditions coupled with beautiful appearance. Full flush doors are interlocked hairline seams on vertical edges and have no visible seams on faces. Doors specified seamless have no visible seams on faces or vertical edges. Face sheets are totally supported by special core used to cover the entire door to delay the heat transfer from one side to another and to avoid burning of people during escape from fire. Top and bottom door edges are closed by 1.5mm inverted steel channel welded in place.



ACOUSTIC FIRE RATED STEEL DOOR AND FRAME

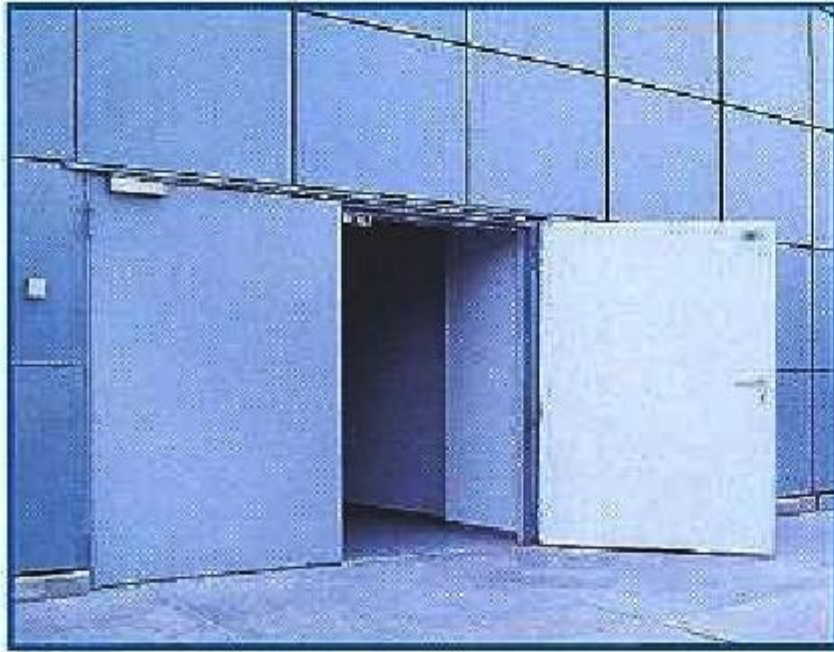

Fire rated acoustic steel doors and frames are designed to control sound as complete unit (doors, frame & sound control gasketing). Full flush doors an interlocked hairline seams on vertical edges and have no visible seams on faces. Doors specified seamless have no visible seams on faces or vertical edges. Face sheets are totally supported by special core used to obtain high STC rating 35 to 50 depending on the project requirement. Acoustic doors and frames are supplied with sound control gasketing as it is part of assembly as shown in the drawing. Top and bottom door edges are closed by 1.5mm inverted steel channel welded in place.

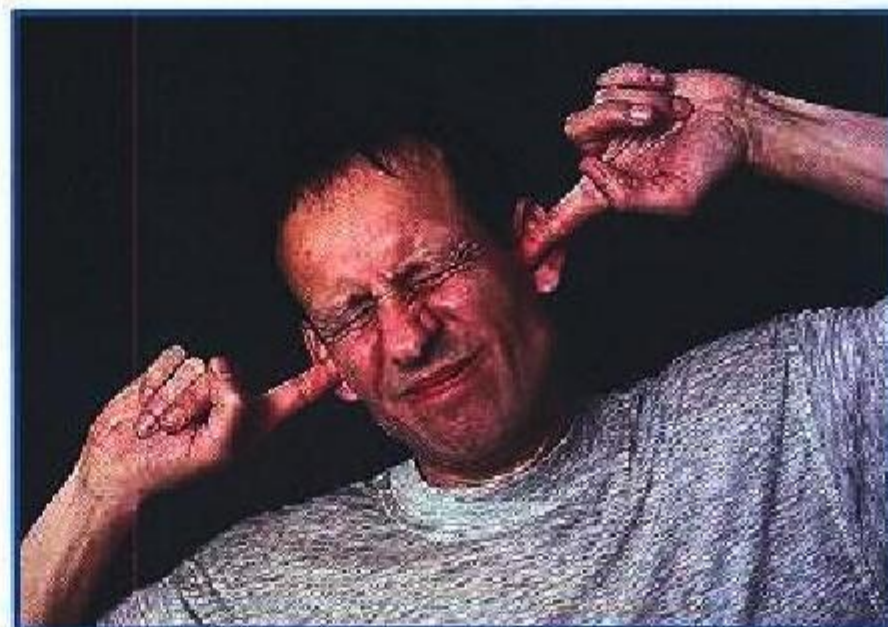
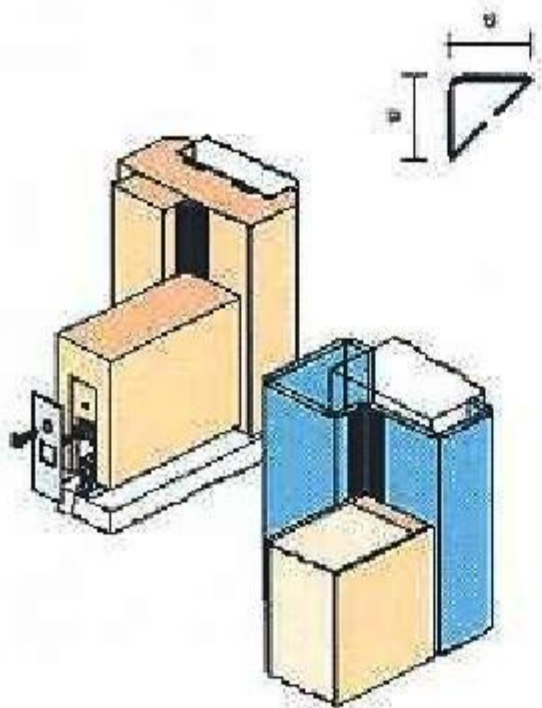

WATER & AIR TIGHT STEEL DOOR AND FRAME

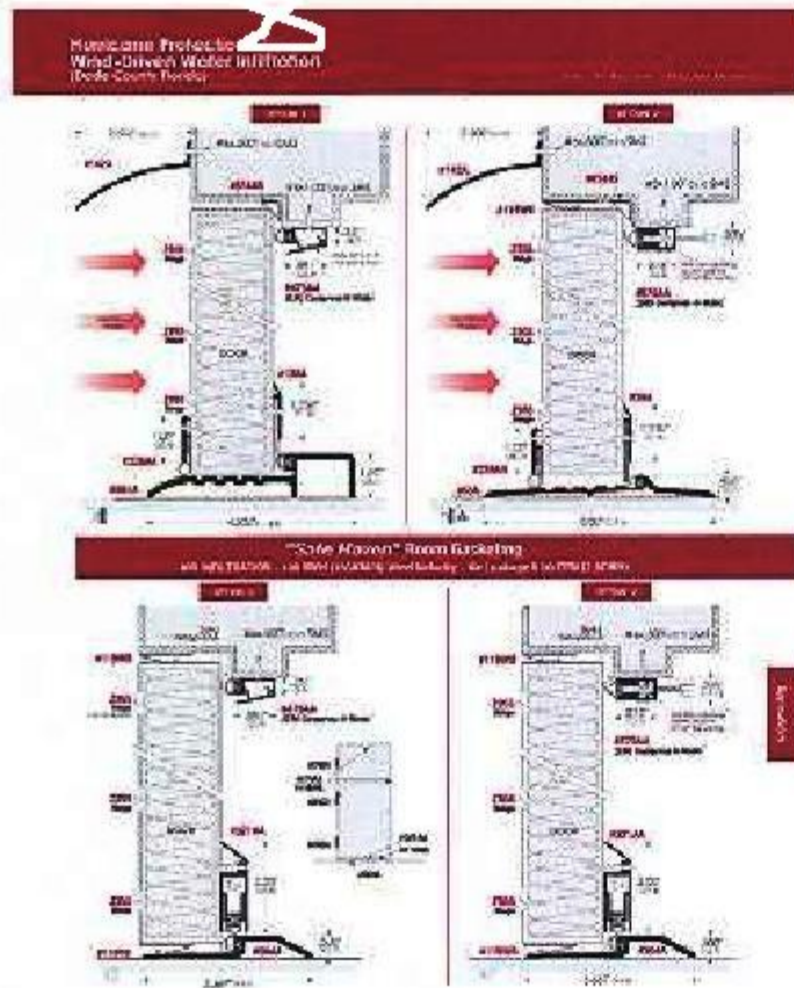

Water & Air tight steel doors and frames are designed to control water & air infiltration as complete unit (doors, frame & water and air tight gasketing). Full flush doors are interlocked hairline seams on vertical edges and have no visible seams on faces. Doors specified seamless have no visible seams on faces or vertical edges. Face sheets are totally supported by special core. Water & Air tight doors and frames are supplied with the special seals to control water & air infiltration. Gasketing is part of the assembly as shown in the drawing. Top and bottom door edges are closed by 1.5mm inverted steel channel welded in place.

X-RAY PROOF STEEL DOOR AND FRAME



X-Ray proof steel doors and frames are designed to protect from harmful rays. Full flush doors are interlocked hairline seams on vertical edges and have no visible seams on faces. Doors specified seamless have no visible seams on faces or vertical edges. Face sheets are totally supported by lead sheet covering the full width and height of the door and frame. The lead thickness is to be equal to the lead in the adjacent wall. The Locks, glass and louvers must be lead shielded by the manufacturer. Top and bottom door edges are closed by 1.5mm inverted steel channel welded in place.



BULLET PROOF STEEL DOOR AND FRAME

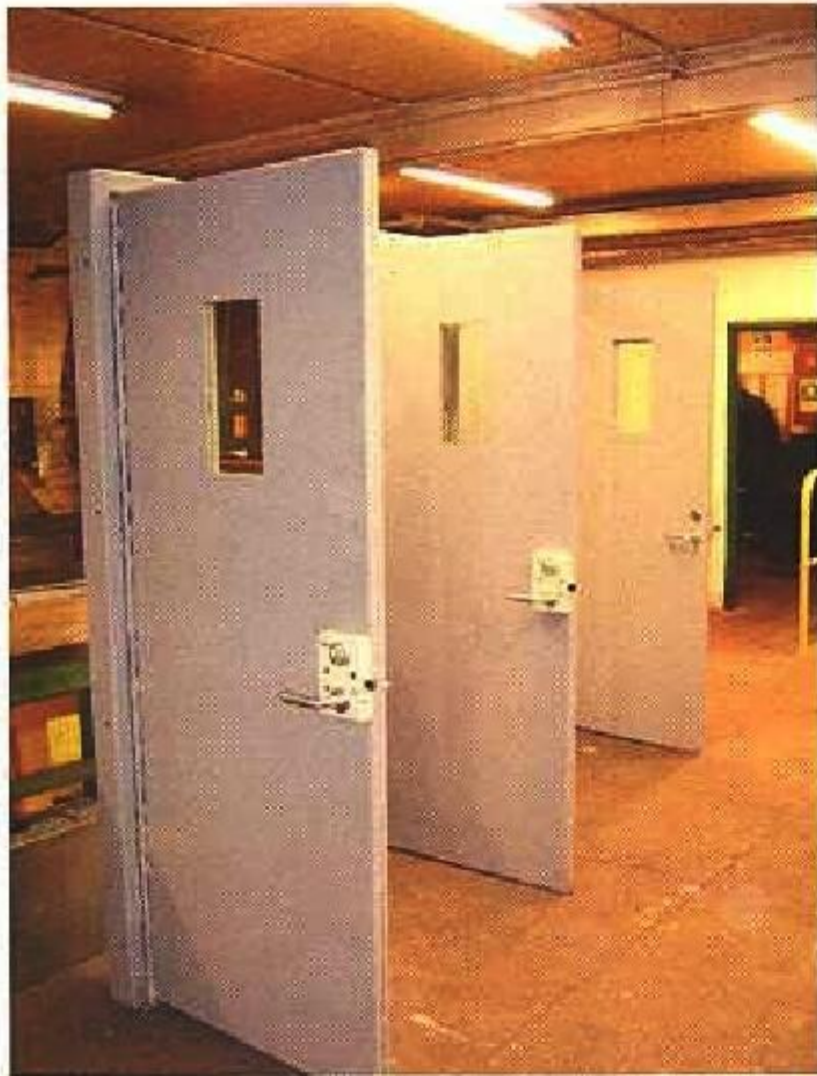

Bullet proof steel doors and frames are designed to protect from even from bullets. Full flush doors an interlocked hairline seams on vertical edges and have no visible seams on faces. Doors specified seamless have no visible seams on faces or vertical edges. Face sheets are totally supported by vertical stiffeners supported with special armor plate to protect from bullets in accordance with UL752 Level 4 up to 32-06 caliber. These doors are supplied complete with frame and hardware. Top and bottom door edges are closed by 2mm steel channel welded in place. Top and bottom edge channels are flush.

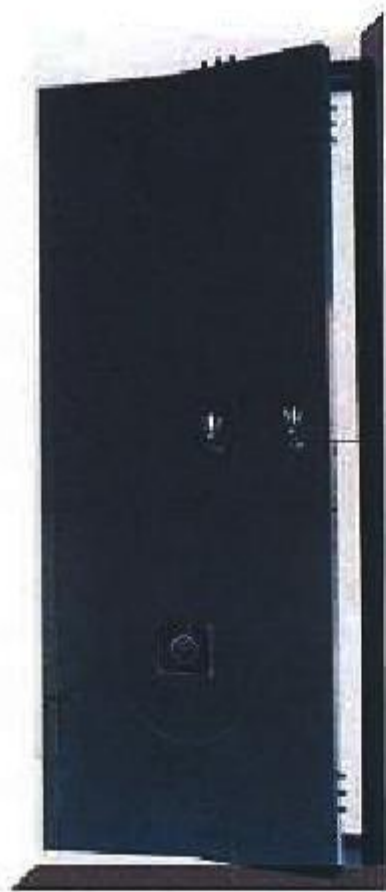

SECURITY STEEL DOOR AND FRAME

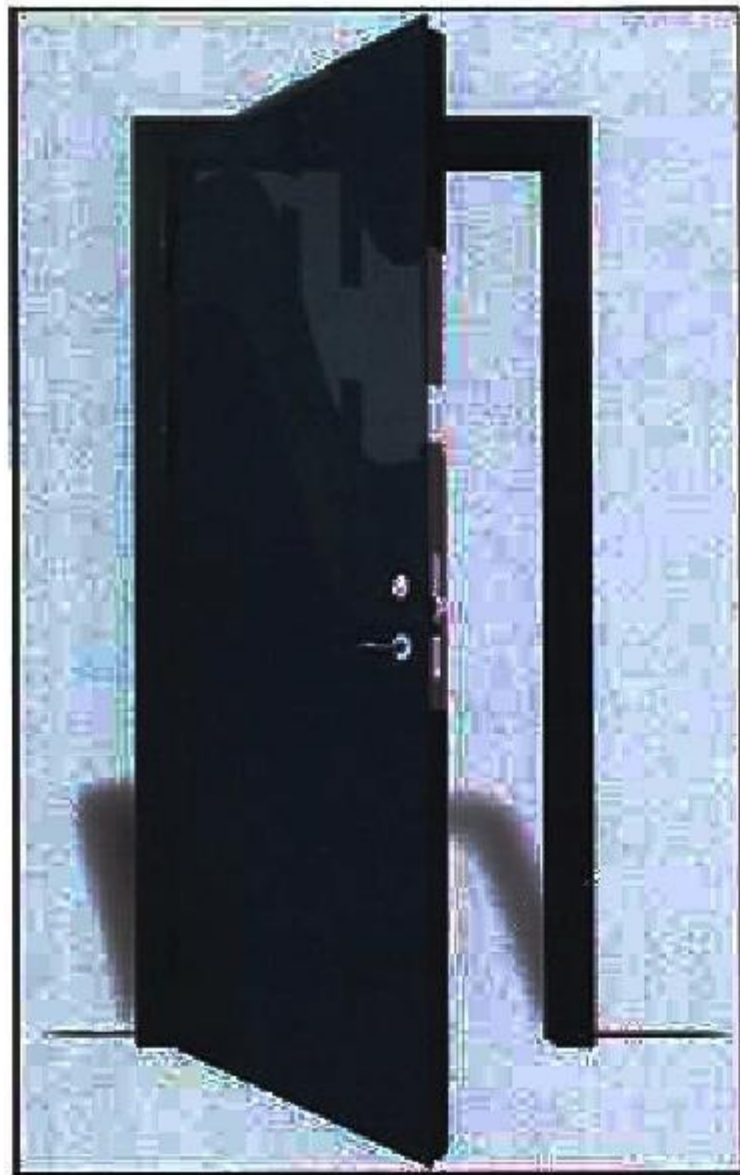

Security steel doors and frames are designed for maximum security in accordance with HMMA 862-87. Doors are supplied seamless with no visible seams on faces or vertical edges. Face sheets are totally supported by 2.0mm thk vertical stiffeners placed on more than 150mm apart and welded on more than 150mm along their length. Fiberglass or Rockwool insulates the area between stiffeners. The top and bottom door edges are closed by 3mm inverted steel channel welded in place.



Heavy duty / Insulated Roller Shutter



16m (W) x 5.5 (H) Heavy Duty Roller Shutter at Army camp, Singapore



Guide for Insulated
Shutters



Insulated Aluminium
slat (19 dB)



Heavy duty slat



Insulated Steel slat (30 dB)

Features :

- Ideal for larger door openings
- Sound and Thermal insulation
- Aluminium double walled slats with PU foam (20dB)
- Steel double walled slats with Rockwool (30dB)
- Guides with PVC strips
- 3mm thick heavy duty steel guides
- Larger shutters with sliding mullions
- Insulated bottom bar with weather seals
- Superior Zinalume / natural anodized finishes
- Optional wind locks
- Optional powder coating and safety edges

Fire Shutters

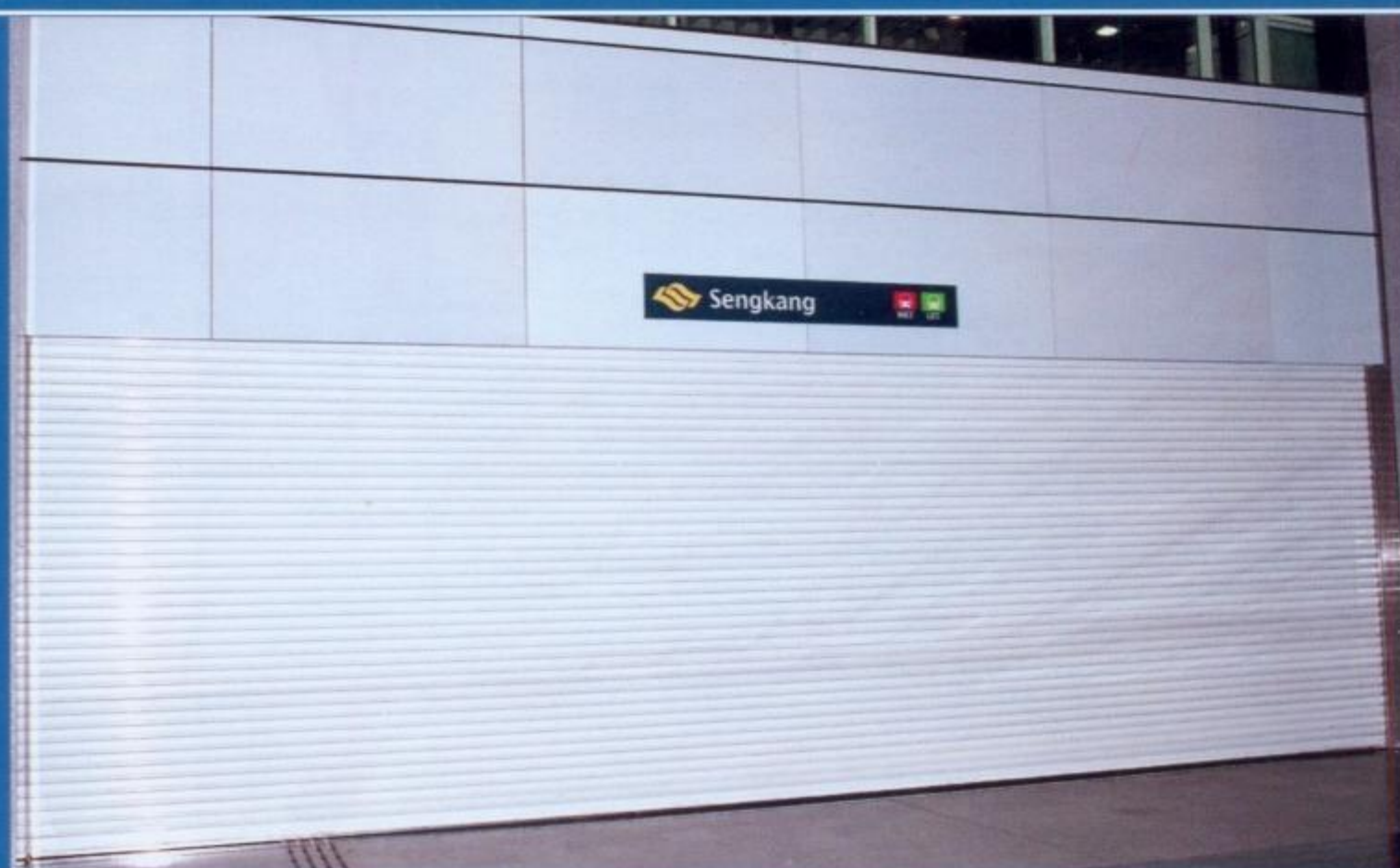

10 m wide fire shutter at sengkang MRT station, Singapore



Fine alarm signal conversion panel



Fusible link



Heavy duty Guide



Solenoid brake releaser
ERS-400

Features ▶

- ▶ 2/4 Hours fire rated
- ▶ Complies with BS 476 part 22, SS 489: 2001
- ▶ Singapore PSB/FSB approved
- ▶ Sizes up to 10m (w) x 4m (h), 9m (w) x 5m (h), 7m (w) x 7m (h) in one panel
- ▶ Larger sizes with special assessment
- ▶ Superior Zincalume steel curtain
- ▶ 3mm thick heavy duty guide
- ▶ Fusible link / Fire alarm signal / Heat / smoke detector activation
- ▶ Optional Colorbond / Powder coated finishes

PROJECT LIST

PROJECT LIST

Project : AL FUTTAIM DUBAI CIVIL AVIATION
HANGAR AT DWC

Main Contractor : KHANSAHEB CIVIL ENGG.

Client : AL FUTTAIM & DCA JOINT VENTURE

Consultant : M/s. BEST (BUREAU OF ENGG. STUDIES
CONSULTING ENGINEERS)

Project : ALTERATIONS & ADDITIONS TO EXISTING
HANGAR AT SAIF ZONE

Main Contractor : ABRAJ BUILDING CONTRACTING CO

Client : VOLGA DNEPR FZE

Project : WAFI GOURMET & CHO GAO AT DUBAI
AIRPORT-CONCOURSE 3

Main Contractor : AMBB INTERIORS L.L.C

Client : WAFI GOURMET & CHO GAO

Project : FERTILISER PLANT.

Main Contractor : ASCON, DUBAI.

Client : SPIC FERTILISERS.

Project : MARKETING SUITE GLAZE SUPPORT
STRUCTURE.

Main Contractor : AL TAYER STOCKS LLC.

Client : DUBAI WORLD TRADE CENTER.

Consultant : M/s. WSP

PROJECT LIST

Project : CINEMAS AT SHARJAH CITY CENTER, IBN BATTUTA MALL, MALL OF THE EMIRATES, SAHARA CENTER, MECATO MALL

Main Contractor : AL TAYER STOCKS LLC.

Project : DUBAI INTL.AIRPORT EXPANSION PHASE-2

Main Contractor : AL NABOODA CIVIL ENGG.

Client : GOVT.OF DUBAI-DEPT OF CIVIL AVIATION

Consultant : M/s. DAR AL-HANDASAH SHIRES & PARTNERS

Project : STEEL SHED & NEW WORKSHOP

Main Contractor : AL RASIKH BUILDING CONTRACTING LLC

Client : AIRMASTER EQUIPMENTS EMIRATES LLC

Consultant : M/s. CAPITAL ENGG.CONSULTANTS

Project : DEIRA CITY CENTER.

Main Contractor : AL TAYER STOCKS LLC.

Client : MAJID AL FUTTAIM

Consultant : HOLFORD ASSOCIATES.

PROJECT LIST

Project : MALL OF THE EMIRATES

Main Contractor : AL TAYER STOCKS LLC.

Client : MAJID AL FUTTAIM

Consultant : M/s. WSP, M/s. JPHP, M/s. RMJM

Project : MUSEUM RING FEATURE STRUCTURE

Main Contractor : ZEBIAN ALUMINIUM & GLASS INDUSTRIES

**Client : HIS HIGHNESS SHK.Dr.SULTAN BIN
MOHAMMED AL QASMI**

Consultant : M/s. CANSULT MAUNSELL

Project : GASCO ABU DHABI RUWAIS PROJECT

**Main Contractor : CHICAGO BRIDGES & IRON EASTERN
ANSTALT**

Client : GASCO.

Project : U.A.E ARMED FORCES SHED.

Main Contractor : EMCO BUILDING CONTRACTING.

Client : DEFENCE AUTHORITY

**Project : SW-246 TAWEELAH ALUMINIUM
SMELTER-ABU DHABI**

Main Contractor : JASAF BLDG.TECHNOLOGY CO.

PROJECT LIST

**Project : ABU DHABI NATION EXHIBITION
ABU-DHABI**

Main Contractor : 3EG CONSULT FZE-SAIF ZONE

Project : DAS ISLAND- ABU DHABI

Main Contractor : 3EG CONSULT FZE-SAIF ZONE

Project : AIR MASTER RAK-RAS AL KHAIMAH

Main Contractor : AIRCONFLEX-RAS AL KHAIMAH

Project : JURF WARE HOUSE (JJM)-AJMAN

Main Contractor : SAQUER AL MULLA GENERAL CONTG.

Project : AMERICAN SCHOOL-AL BARSHA, DUBAI

Main Contractor : 3EG CONSULT FZE-SAIF ZONE

Project : JEBEL ALI FZC WARE HOUSE-DUBAI

Main Contractor : MULTILINK CONTRACTING CO LLC.

Project : BUSINESS BAY OFFICE TOWER-DUBAI

Main Contractor : EMBASI ELECTRO MECH. L.L.C

PROJECT LIST

Project : LABNEH WA ZATAR-DUBAI

Main Contractor : DOORS & KNOBS L.L.C-DXB

Project : VETERINARY CLINIC-AL BARSHA

Main Contractor : ARIF MOHAMMED TECHNICAL SERVICES

Project : EXCELAR- 5 STAR HOTEL-AL BARSHA

Main Contractor : ARIF MOHAMMED TECHNICAL SERVICES

Project : EMERALD PALACE-PALM JUMEIRAH-DXB

Main Contractor : DOORS & KNOBS L.L.C-DXB

Project : ABU DHABI AIRPORT-ABU DHABI

Main Contractor : ELEMENT UNIT DESIGN

PROJECT LIST

Project : **MABANI STEEL – SOUTH AFRICA**
Main Contractor : **DESERT ROOFING & FLOORING**

Project : **CENTRO HOTEL – SHARJAH AIRPORT**
Main Contractor : **GUSTAV PEGEL**

Project : **WARE HOUSE – ABU DHABI**
Main contractor : **READY MIX BETON**

Project : **SIDDIQUI AND SONS – DUBAI**
Main Contractor : **ARIF MOHAMMED TECHNICAL SERVICE**

Project : **JABEL ALI FREE ZONE WAREHOUSE – HOUSE**
Main Contractor : **CLARION LOGISTICS MIDDLE**

Project : **SAADIYAT BEACH CLUB HOTEL**
Main Contractor : **KHANSAHEB**

Project : **MASOOD BURGEM PORTACABIN**
Main Contractor : **DOORS & KNOBS L.L.C. – DXB**

Project : **AL KAWATHAR CONT – DUBAI**
Main Contractor : **DOORS & KNOBS L.L.C. – DXB**

PROJECT LIST

Project : **AL ATAR TOWER – DUBAI**
Main Contractor : **GULF INTERNATIONAL TRADING**

Project : **BULLET PROOF WINDOWS – AFGHANISTAN**
Main Contractor : **UNITY LOGISTICS**

Project : **CHICAGO – DUBAI**
Main Contractor : **DOORS & KNOBS L.L.C. – DXB**

Project : **DUBAI POLICE H.Q. – DUBAI**
Main Contractor : **ADVANCE CREATIVE TECH. SER. LLC**

Project : **ABU DHABI PROJECT**
Main Contractor : **SILVER CROWN METAL WORKS**
Client : **Mr. GANESH NARAYAN**

Project : **N.I. MODEL SCHOOL – AJMAN**
Main Contractor : **AL TABYAN BLDG. CONSTRUCTION**

Project : **JUMEIRAH ENGLISH SCHOOL – DUBAI**
Main Contractor : **AMBB CIVILS & CONSTRUCTION**

Project : **LAGOONA BEACH – AJMAN**
Main Contractor : **DOORS & KNOBS L.L.C. – DXB**

PROJECT LIST

Project : **GLOBAL STEEL – AL AIN**
Main Contractor : **ADVANCE CREATIVE TECH. SER. L.L.C**

Project : **SPORTS CENTER – BAHRAIN**
Main Contractor : **AL LIWAN CONTRACTING**

Project : **BLUE FINE – DUBAI**
Main Contractor : **DOORS & KNOBS L.L.C – DXB**

Project : **AFGHANISTAN PROJECTS –**
AFGHANISTAN
Main Contractor : **DOORS & KNOBS L.L.C – DXB**

Project : **ROTANA HOTEL – DUBAI**
Main Contractor : **DOORS & KNOBS L.L.C – DXB**

Project : **BLUE FINE**
Main Contractor : **PRESTIGE BUILDING**

Project : **RAK PREFAB – RAS AL KHAIMAH**
Main Contractor : **RAK PREFABS LLC**

Project : **GLOBAL STEEL**
Main Contractor : **ADVANCE CREATIVE**

PROJECT LIST

Project : **NIMS WAREHOUSE – AJMAN**
Main Contractor : **PRESTIGE BUILDING CONTRACTOR**

Project : **SW 269 NEW OFFICE LABS – DUBAI**
Main Contractor : **JASAF BLDG TECH**

Project : **AL AIN UNIVERSITY – AL AIN**
Main Contractor : **AL FUTTAIN CARILLION**

Project : **TAWAM HOSPITAL – AL AIN**
Main Contractor : **ADVANCE CREATIVE**

Project : **LABOUR CAMP – DUBAI**
Main Contractor : **MAHAMMAD OMAR BIN HAIDER**

COMPANY LISTINGS

Certificate of Compliance

Certificate Number **20101005- R26618**
Report Reference **R26618, 2010 September 29**
Issue Date **2010 October 05**

Page 2 of 1



**Underwriters
Laboratories Inc.®**

Issued to: **ADVANCE METAL INDUSTRIES L L C**
PO BOX 3180,
AJMAN UNITED ARAB EMIRATES.

*This is to certify that
representative samples of* **Swinging-type Fire Doors**
For model information please refer to the addendum.

*Have been investigated by Underwriters Laboratories Inc.® in
accordance with the Standard(s) indicated on this Certificate.*

Standard(s) for Safety: The basic standards used to investigate products in this category are ANSI/UL
10B, "Fire Tests of Door Assemblies.

Additional Information: See UL On-Line Certification Directory at www.UL.com under alternate listee
file number R26867 for additional information.

Look for the UL Listing Mark on the product

Only those products bearing the UL Listing Mark should be considered as being covered by UL's Listing and Follow-Up Service.

The UL Listing Mark generally includes the following elements: the symbol UL in a circle:  with the word "LISTED"; a control number (may be alphanumeric) assigned by UL; and the product category name (product identifier) as indicated in the appropriate UL Directory.

William R. Carney,

Director of the North American Certification Program,

Underwriters Laboratories Inc.

Any information and documentation involving UL Mark Services are provided on behalf of Underwriters Laboratories Inc (UL) or any authorized licensees of UL.
For questions in India, you may call 91-80-4138 4400, UL India Pvt. Ltd.

Certificate of Compliance

Certificate Number **20101005- R26618**
Report Reference **R26618, 2010 September 29**
Issue Date **2010 October 05**

Page 2 of 2



This is to verify that representative samples of the product as specified on this certificate were tested according to the current UL requirements.

Swinging doors may be provided as follows:

Max Rating	Opening Type	Hollow Metal Type Door	Steel Covered Composite Type Door
2 Hr	Single	—	X
	Single Point Lock		
	Single Rim/Mortise Fire Exit Hardware		

William R. Carney:

Director of the North American Certification Program.

Underwriters Laboratories Inc.

Any information and documentation involving UL Mark Services are provided on behalf of Underwriters Laboratories Inc (UL) or any authorized licensee of UL.
For questions in India, you may call 91-80-4138 4400, UL India Pvt. Ltd.

Certificate of Compliance

Certificate Number: 20100420-R26670
Report Reference: R26630, 2010 March 12
Issue Date: 2010 April 20

Page 1 of 1



Issued to: ADVANCE METAL INDUSTRIES L L C

PO BOX 3180
AJMAN UNITED ARAB EMIRATES

*This is to certify that
representative samples of*

FIRE DOOR AND WINDOW FRAMES

The single-unit type, pressed-steel frames for walls at least 2 inches (50.8 mm) thick.

*Have been investigated by Underwriters Laboratories Inc.® in
accordance with the Standard(s) indicated on this Certificate.*

Standard(s) for Safety:

UL 63 - OUTLINE OF INVESTIGATION FOR FIRE DOOR FRAMES –
Edition 4

Additional Information:

AIR MASTER EQUIPMENTS EMIRATES L L C

See UL On-Line Certification Directory at www.UL.com for additional
Information.

Only those products bearing the UL Listing Mark should be considered as being covered by UL's Listing and Follow-Up Service.

The UL Listing Mark generally includes the following elements: the symbol UL in a circle:  with the word "LISTED"; a control number (may be alphanumeric) assigned by UL; and the product category name (product identifier) as indicated in the appropriate UL Directory.

Look for the UL Listing Mark on the product

William R. Carney,
Director of the North American Certification Program.

Underwriters Laboratories Inc.

Any information and documentation involving UL Mark Services are provided on behalf of Underwriters Laboratories Inc (UL) or any authorized licensee of UL.
For questions in India, you may call 91-80-4138 4400, UL India pvt. Ltd



**GSYX.R26867
Swinging-type Fire Doors**

Page Bottom

Swinging-type Fire Doors

See General Information for Swinging-type Fire Doors

ADVANCE METAL INDUSTRIES L L C
PO BOX 3180
AJMAN, UNITED ARAB EMIRATES

R26867

Swinging doors may be provided as follows:

Max Rating	Opening Type	Hollow Metal Type Door	Steel Covered Composite Type Door
2 Hr	Single	—	X
	Single Point Lock		
	Single Rim/Mortise Fire Exit Hardware		
2 Hr	Pair with Astragal	—	X
	Single Point Lock/Flush Bolts		
	Vertical Rod/Mortise Fire Exit Hardware		

Last Updated on 2010-12-01

[Questions?](#)

[Print this page](#)

[Notice of Disclaimer](#)

[Page Top](#)

Copyright © 2011 Underwriters Laboratories Inc.®

The appearance of a company's name or product in this database does not in itself assure that products so identified have been manufactured under UL's Follow-Up Service. Only those products bearing the UL Mark should be considered to be Listed and covered under UL's Follow-Up Service. Always look for the Mark on the product.

UL permits the reproduction of the material contained in the Online Certification Directory subject to the following conditions: 1. The Guide Information, Designs and/or Listings (files) must be presented in their entirety and in a non-misleading manner, without any manipulation of the data (or drawings). 2. The statement "Reprinted from the Online Certifications Directory with permission from Underwriters Laboratories Inc." must appear adjacent to the extracted material. In addition, the reprinted material must include a copyright notice in the following format: "Copyright © 2011 Underwriters Laboratories Inc.®"

An independent organization working for a safer world with integrity, precision and knowledge.





**GVTV.R26670
Fire Door and Window Frames**

[Page Bottom](#)

Fire Door and Window Frames

[See General Information for Fire Door and Window Frames](#)

ADVANCE METAL INDUSTRIES L L C
PO BOX 3180
AJMAN, UNITED ARAB EMIRATES

R26670

Door Frames for use as a component in fire door assemblies that meet the requirements of UL 10C:

Three-sided steel frame with or without transoms, single swing and pairs.

Door Frames for use as a component in fire door assemblies that meet the requirements of UL 10B (neutral pressure):

Three-sided frames with or without transom, single swing and pairs.

[Last Updated](#) on 2010-03-16

[Questions?](#)

[Print this page](#)

[Notice of Disclaimer](#)

[Page Top](#)

Copyright © 2011 Underwriters Laboratories Inc.®

The appearance of a company's name or product in this database does not in itself assure that products so identified have been manufactured under UL's Follow-Up Service. Only those products bearing the UL Mark should be considered to be Listed and covered under UL's Follow-Up Service. Always look for the Mark on the product.

UL permits the reproduction of the material contained in the Online Certification Directory subject to the following conditions: 1. The Guide Information, Designs and/or Listings (files) must be presented in their entirety and in a non-misleading manner, without any manipulation of the data (or drawings). 2. The statement "Reprinted from the Online Certifications Directory with permission from Underwriters Laboratories Inc." must appear adjacent to the extracted material. In addition, the reprinted material must include a copyright notice in the following format: "Copyright © 2011 Underwriters Laboratories Inc.®"

An independent organization working for a safer world with integrity, precision and knowledge.





**GSYX.R26867
Swinging-type Fire Doors**

[Page Bottom](#)

Swinging-type Fire Doors

See [General Information for Swinging-type Fire Doors](#).

ADVANCE METAL INDUSTRIES L L C
PO BOX 3180
AJMAN, UNITED ARAB EMIRATES

R26867

Swinging doors may be provided as follows:

Max Rating	Opening Type	Hollow Metal Type Door	Steel Covered Composite Type Door
2 Hr	Single	—	X
	Single Point Lock		
	Single Rim/Mortise Fire Exit Hardware		
2 Hr	Pair with Astragal	—	X
	Single Point Lock/Flush Bolts		
	Vertical Rod/Mortise Fire Exit Hardware		

Last Updated on 2010-12-01

[Questions?](#)

[Print this page](#)

[Notice of Disclaimer](#)

[Page Top](#)

Copyright © 2011 Underwriters Laboratories Inc.®

The appearance of a company's name or product in this database does not in itself assure that products so identified have been manufactured under UL's Follow-Up Service. Only those products bearing the UL Mark should be considered to be Listed and covered under UL's Follow-Up Service. Always look for the Mark on the product.

UL permits the reproduction of the material contained in the Online Certification Directory subject to the following conditions: 1. The Guide Information, Designs and/or Listings (files) must be presented in their entirety and in a non-misleading manner, without any manipulation of the data (or drawings). 2. The statement "Reprinted from the Online Certifications Directory with permission from Underwriters Laboratories Inc." must appear adjacent to the extracted material. In addition, the reprinted material must include a copyright notice in the following format: "Copyright © 2011 Underwriters Laboratories Inc.®"

An independent organization working for a safer world with integrity, precision and knowledge.



The image shows a cover for a product catalogue. It features a thick blue border. In the center, the words "PRODUCT CATALOGUE" are written in a large, bold, blue, serif font. The text is contained within a white rectangular area that has a blue border and decorative scroll-like elements at the top and bottom corners.

PRODUCT CATALOGUE



ادفانس للمصناعات المعدنية ذ.م.م.
ADVANCE METAL INDUSTRIES L.L.C.

Fire Doors & Frames



Copyright reserved for ADVANCE METAL

"Due to continuous progress and product improvement, ADVANCE METAL reserves the right to make changes without notice"





DISCLAIMER OF WARRANTIES: ADVANCE METAL products are designed on “SDI”, “NFPA”, technological data in the interest of improving the safety for the public benefit. ADVANCE METAL disclaims any liability for any personal injury, loss of life, property damage, or other damage of any nature whatsoever, whether special, indirect, consequential or compensatory, direct or indirectly resulting from any accident, regardless of legal theory. In no event shall ADVANCE METAL’s liability exceed the amount paid by the customer / contractor to that individual product cost OR US\$1000/- whichever is lesser, regardless of legal theory.

Note: Steel Doors once install, needs to be strictly maintained for every month and operation performance should be recorded by trained engineer or concern department experts, as per the Operation and Maintenance manual.

BREAKS

Fire & Smoke Path



ADVANCE METAL Steel Doors are design based on SDI and NFPA technological data in the interest of improving the safety for the public benefits.

Today as per the BOCA International standards, building safety is a demandable choice by the public, in case of fire accidents. ADVANCE METAL fire rated Steel Doors are produced with the toughest UL and SDI standards to prevent any spread of smoke fire breakup. For more details about ADVANCE METAL UL listed products contact on Tel: +9716 7436900

FIRE RATED STEEL DOOR SPECIFICATIONS

GENERAL

Scope:

This specification applies to standard steel doors as shown on the plan and door schedules and as manufactured by ADVANCE METAL INDUSTRIES L.L.C.

Quality Assurance:

ADVANCE METAL will provide doors in compliance with ANSI/SDI-100 requirements. ADVANCE METAL will provide fire rated doors labeled and listed by Underwriters Laboratories Inc. (or) warringtonfire mideast.

PRODUCT

Door Construction:

45mm (1³/₄") thick full flush construction with the details confirming to SDI-111A-EDGE considered.

Manufactured from cold rolled steel sheets to ASTM A366 or from galvanized steel to ASTM A526. Available in nominal 1.2mm (18ga.) or 1.5mm (16ga.).

Vertical edges are interlocked.

1.5mm (16ga.) deep end channels at top and bottom of door for lasting integrity.

Hardware reinforcing in accordance to ANSI, SDI, NFPA standards requirements.

Tested according to UL10(B) and labelled up to 3 hours. Available with wide range of glass light and louver preparations.

Fire rated, Labeled: Available in sizes up to 4'x8' single and 8'x8' double. Larger sizes are also available with oversize certification.

HARDWARE PREPARATION

Hinge Preparation:

ADVANCE METAL will provide doors with 4.0mm thick steel hinge reinforcements welded to the doors in compliance with SDI-100. Standard hinge preparation is to be 41/2"x4" for regular weight 0.134" thick hinge, three preparations through 2286mm (7'6") height and four preparations over 2286mm (7'6") and up to 3048mm (10') height in compliance with NFPA 80.

Lock Face Plate Preparation:

ADVANCE METAL will provide Doors with 3.0mm thick steel lock face plate reinforcement with tapped holes welded to the Doors.

Standard lock preparation is to be provided in compliance with ANSI A115.2.

Closer and Other Reinforcement:

Advance Metal will provide all doors with minimum 2.0mm (14gauge) reinforcement as necessary to support the scheduled hardware in compliance with ANSI/SDI-100. Drilling and tapping for surface applied hardware to be performed at the building site by others.



Glazing:

Doors are to be provided with steel channel glazing beads for installation of glazing. Installation of glazing by others.

Painting:

After fabrication Door thoroughly cleaned (to assure proper adhesion) and polyester powder coated finish applied. Wooded finish paint will be provided as a optional finish.

FIRE PROTECTION:

Labeled fire rated Door tested in accordance with UL (or) Warringtonfire-mideast with rating as specified in the plans and door schedule. Fire door frames are to be manufactures by Advance Metal in accordance with the approved procedures issued by UL (or) Warringtonfire-mideast.

Labels:

Fire rated Door shall bear the appropriate fire labels.

Execution:

Installation of the frames plumb, square and in true alignment in compliance with SDI-122. Installation and troubleshooting guide for standard steel doors and frames.

FIRE DOOR TYPES - DF

- AM-100 Series - Honeycomb core door
- AM-200 Series - Polystyrene core door
- AM-300 Series - Stiffened Door with fiberglass insulation
- AM-400 Series - Stiffened Door with Rock wool insulation
- AM-500 Series - Polyurethane core door

- AMEM-100 Series - Embossed steel doors-honeycomb
- AMEM-200 Series - Embossed steel doors (Fire rated) honeycomb

- AMSS-100 Series - Stainless steel hollow metal honeycomb core door
- AMSS-200 Series - Stainless steel hollow metal door
- AMSS-300 Series - Stainless steel hollow metal door with fiberglass insulation
- AMSS-400 Series - Stainless steel hollow metal door with fiberglass insulation
- AMSS-500 Series - Stainless steel hollow metal door Polyurethane door

Single Door



Double Door



TYPICAL DOOR TYPES

Double Door Elevation

Single Door Elevation

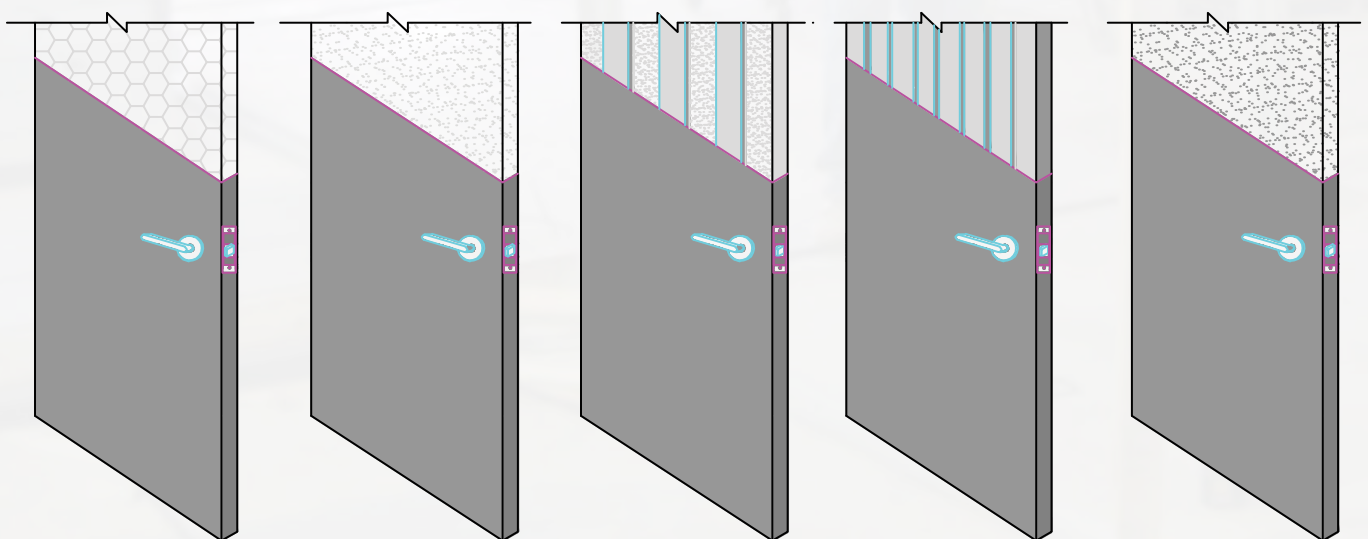
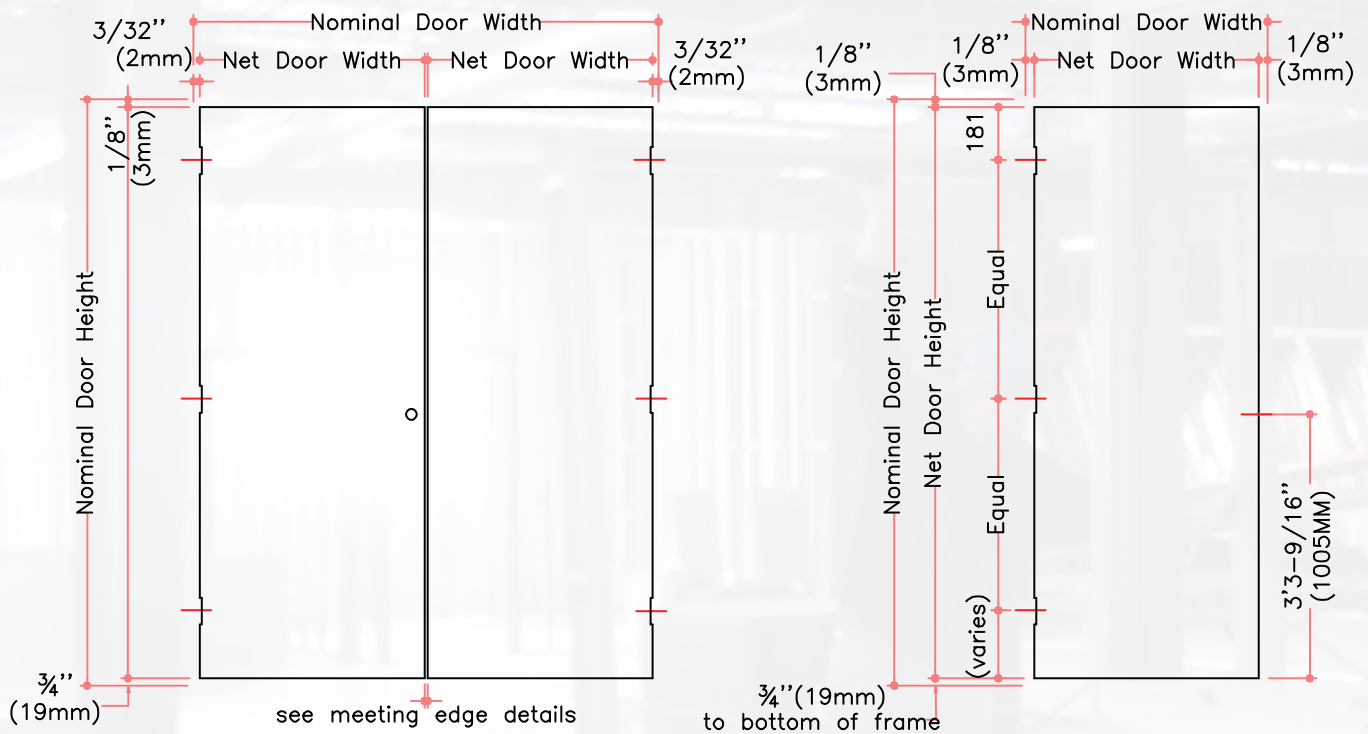

AM-100 Series
Honey Comb Core

AM-200 Series
Polystyrene Core

AM-300 Series
Steel stiffened with
Fiberglass

AM-400 Series
Steel stiffened with
rock wool

AM-500 Series
Polyurathane Core

TYPICAL ELEVATIONS

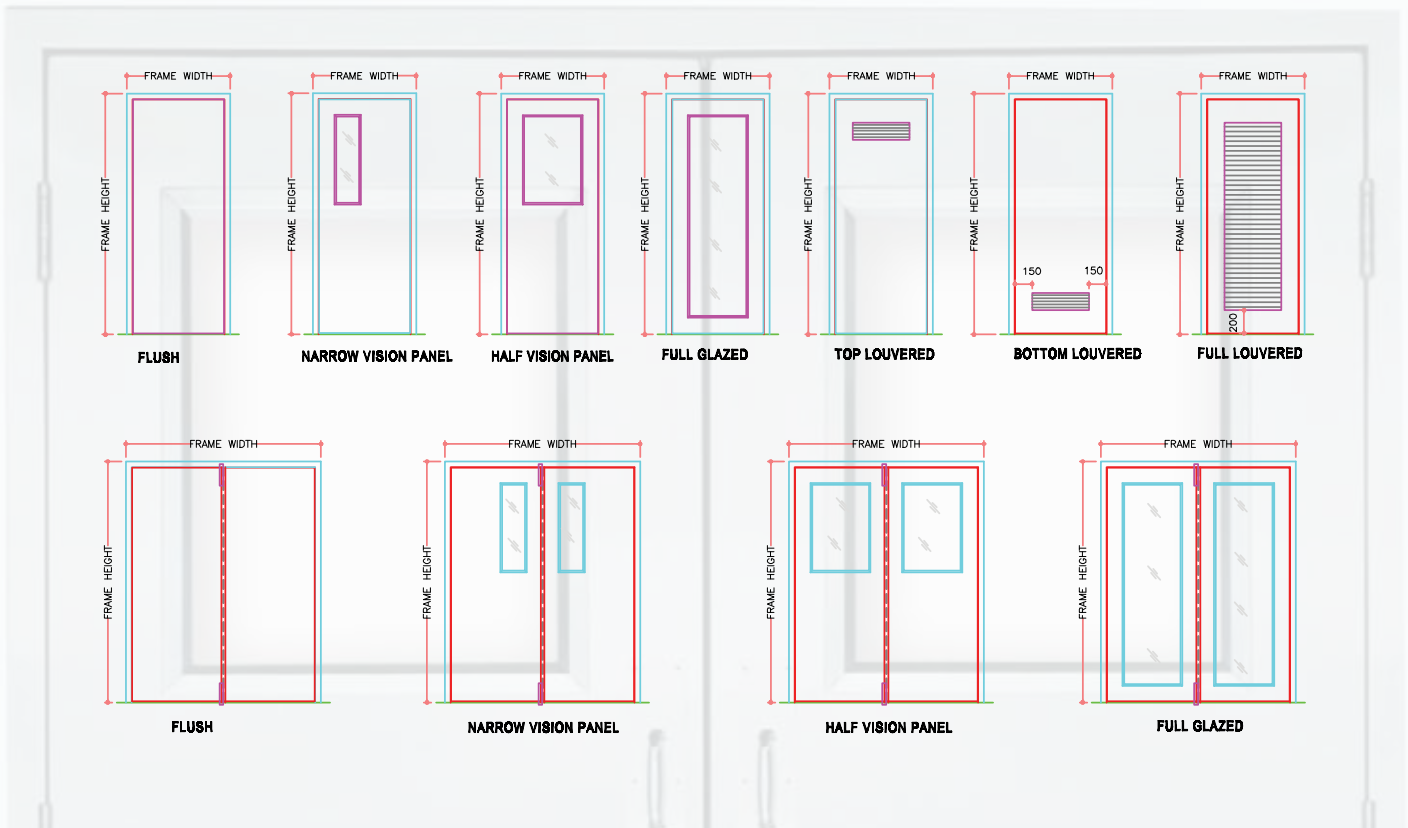

AM-100 Series: Pre-foamed Honey Comb bonded to both Door skins using a heated power press thus ensuring maximum adhesion and flat warp and distortion free panel.

AM-200 Series: Pre-foamed polystyrene slab of 18Kg/m³(1.12pcf) density, filling the inside of the door and secured to face skins with adhesive.

AM-300 Series: Constructed using 0.8mm (22 gauge) thick vertical steel stiffeners welded to each face of the door at 100mm centers and spaced 190mm centers. Voids filled with fiberglass insulation.

AM-400 Series: Constructed using 0.8mm (22 gauge) thick vertical steel stiffeners welded to each face of the door at 100mm centers and spaced 190mm centers. Voids are filled with rock wool insulation.

AM-500 Series: Foamed-in-place polyurethane core exceeding 35Kg/m³(2.18 pcf) compressed density, entirely filling the inside of the door.

FIRE RATED STEEL FRAME SPECIFICATIONS:

1.0 GENERAL:

Scope:

This specification applies to standard steel frames as shown on the plan and door schedules and as manufactured by Advance Metal Industries LLC.

Quality Assurance:

Advance Metal will provide frames in compliance with ANSI/SDI-100 requirements. Advance Metal will provide fire rated frames labeled and listed by UL (or) Warringtonfire-mideast.

PRODUCT:

Frame Construction:

Frames are constructed of 1.2mm (18 gauge) or 1.5mm (16 gauge) or 2mm (14 gauge) or 2.5mm (12 gauge) commercial quality cold rolled steel ASTM A366 or hot dip galvanized steel sheet ASTM A526, G90 for doors of either 45mm (1³/₄"") or 35mm (1³/₈"") thickness with the details conforming to SDI-111A. All bends shall be formed with a true sharp radii.

Welded Frames:

Welded frames will be factory assembled, face welded and ground smooth. All welded frames will include the appropriate anchors to match the wall construction they are intended to be installed.

Knocked Down Frames:

All KD frames will include the appropriate anchors to match the wall construction, they are to be installed with appropriate reinforcement.

Architectural Entrances, Sidelites and Borrowed Lites:

Advance Metal will provide all architectural entrances, sidelites and borrowedlites fabricated from 1.5mm(16gauge) cold rolled or hot dipped galvanized steel sheet. Construction, preparations and profiles to match masonry frames. All mullion sections to be closed. All joints and corners of the assembly shall be face welded and ground smooth. Advance Metal will provide steel channel glazing beads for all areas with glass. Field joints shall be permitted when the size of the total assembly exceeds shipping limitation.

Hardware Preparation:

Hinge Preparation:

Advance Metal will provide frames with 4.0mm thick steel hinge reinforcements welded to the frames in compliance with SDI-100. Standard hinge preparation is to be 41/2"x4" for regular weight 0.134" thick hinge, three preparations through 2286mm(7'6") height and four preparations over 2286mm (7'6") and up to 3048mm(10') height in compliance with NFPA 80.

Strike Preparation:

Advance Metal will provide frames with 3.0mm thick steel lock strike reinforcement with tapped holes welded to the frames. Standard strike preparation is to be for 2³/₄" or 4⁷/₈" strike in compliance with ANSI A115.1 or A115.2



Closer and Other Reinforcement:

Advance Metal will provide all frames with minimum 2.0mm(14 gauge) reinforcement as necessary to support the scheduled hardware in compliance with ANSI/SDI-100. Drilling and tapping for surface applied hardware to be performed at he building site by others.

Plaster Guard:

Advance Metal will provide 1.2mm thick steel plaster guard or mortar boxes at the back of hardware cut-outs in the frames.

Glazing:

Frames are to be provided with steel channel glazing beads for installation of glazing. Installation of glazing shall be by others.

Painting:

After fabrication frames thoroughly cleaned (to assure proper adhesion) and polyester powder coated finish applied. Wood-en finish paint will be provided as a optional finish.

FIRE PROTECTION:

Labeled fire rated door frames tested in accordance with UL (or) Warringtonfire-mideast with rating as specified in the plans and door schedule. Fire door frames are to be manufactured by Advance Metal in accordance with the approved procedures issued by UL (or) Warringtonfire-mideast.

Labels:

Fire rated frames shall bear the appropriate fire labels.

EXECUTION:

Installation of the frames plumb, square and in true alignment in compliance with SDI-122 installation and troubleshooting guide for standard steel doors & frames.

STEEL DOOR FRAME ELEVATION

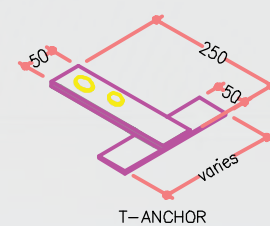
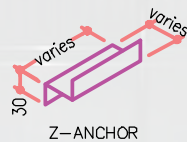
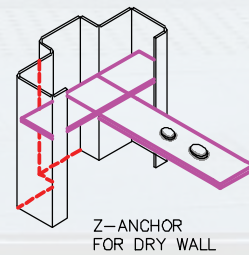
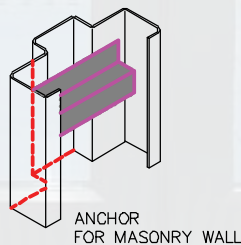
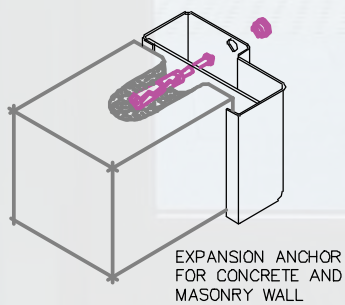
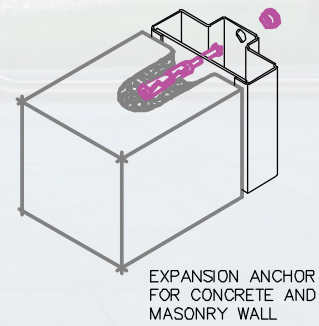
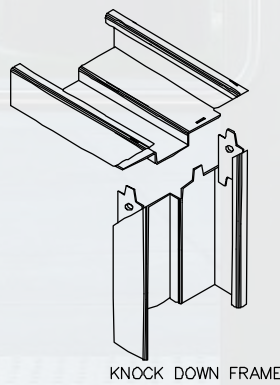
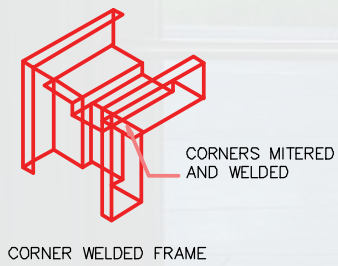
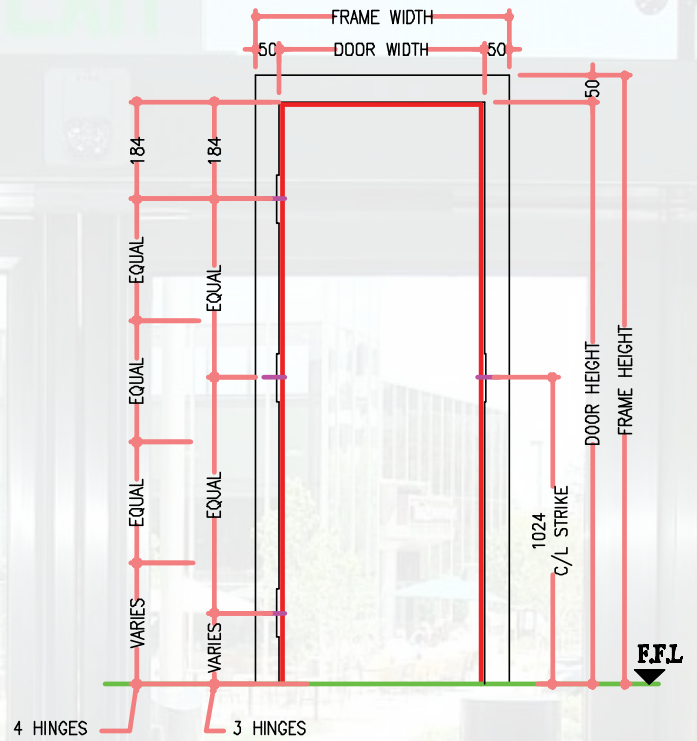

TYPICAL PROFILE DETAIL

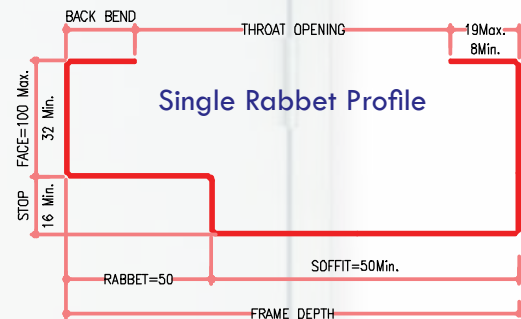
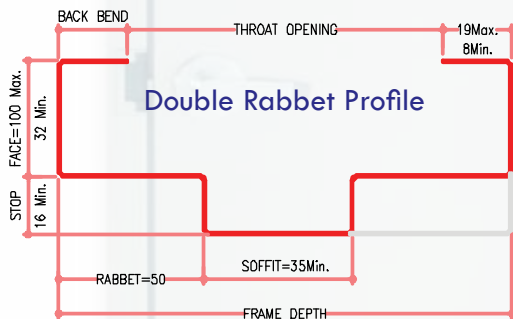
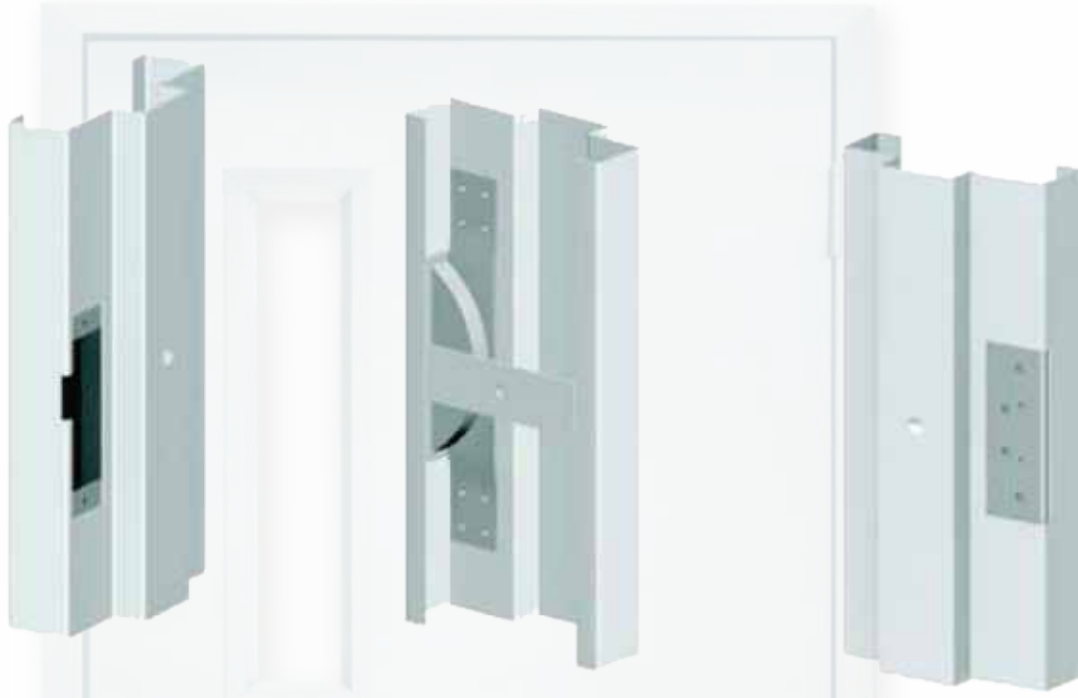

Labeled frames shall be fabricated from cold rolled or galvanized steel sheet. Bends shall be brake formed to assure true, sharp radius, and to minimize camber. Labeled Masonry and Dry Wall frames can be shipped either knockdown or welded. Transom frames shall be shipped welded only. Standard hardware preparations for labeled fire door frames for 45mm. (1 3/4") thick doors Max. 3Hrs. Fire Label provided.

FRAME PROFILES

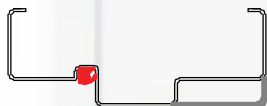

GROOVE TYPE FRAME
RABBET SIDE

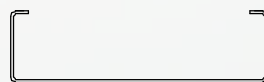

CASEMENT



DOUBLE EGRESS FRAME



GROOVE TYPE FRAME
STOP SIDE



ADJUSTABLE FRAME



TRANSOM BAR/MULLION

TYPICAL DETAILS

TRANSOM FRAMES

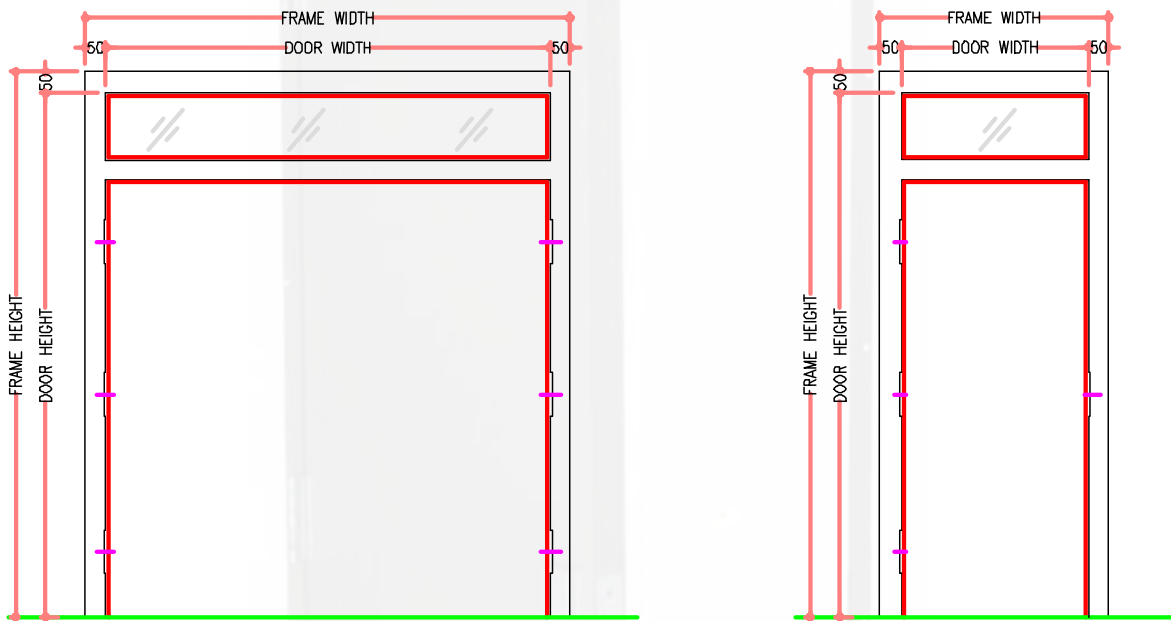

- Max. Overall Frame Size:
1320x3100mm. for Single;
2540x3100mm. for pair.

- Transom Frames must be shipped from factory as set-up welded units with panels installed.

FIRE WINDOW FRAMES

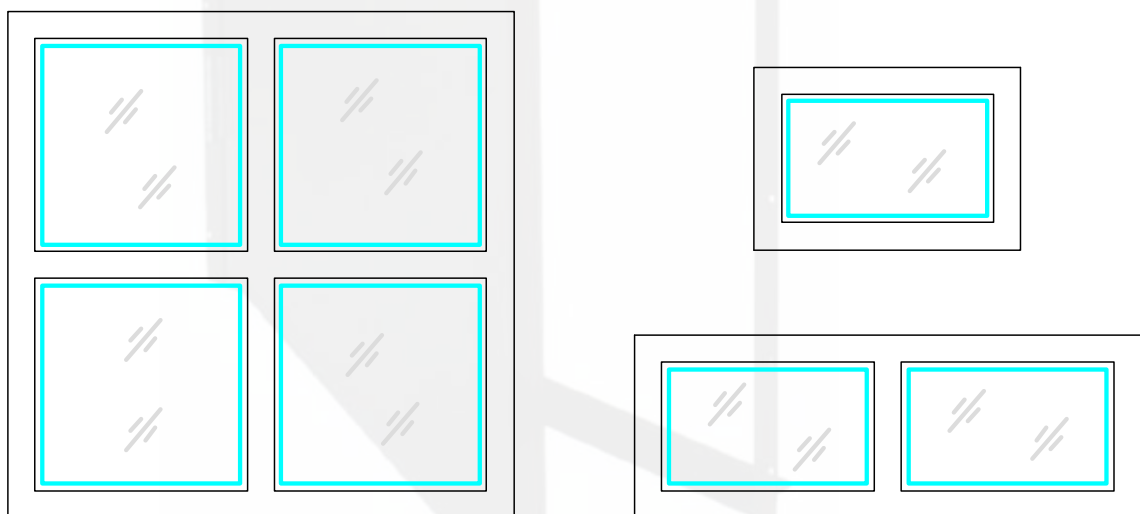

TYPICAL ELEVATIONS

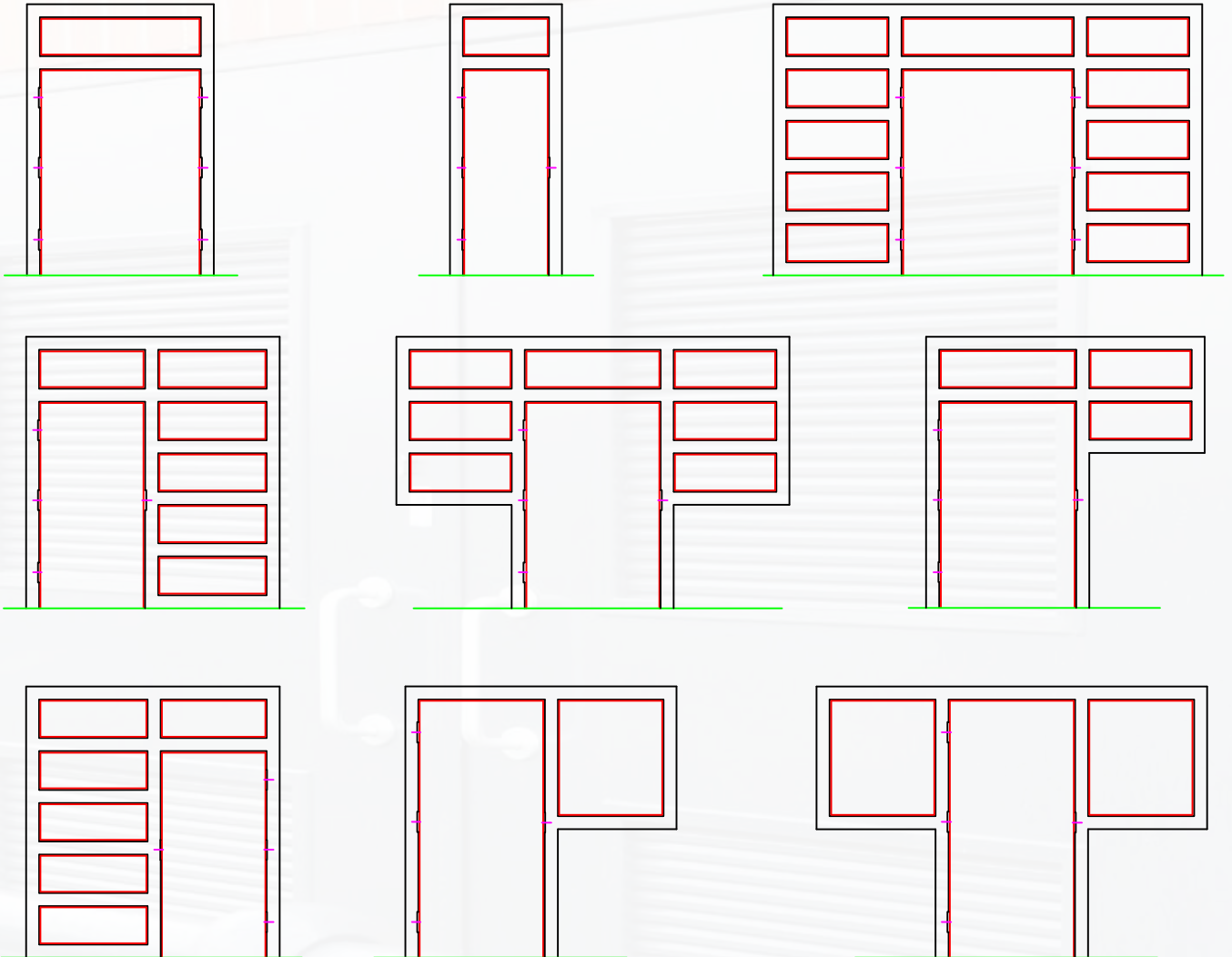

Transom side light frames may be of 1.5mm. (16ga.) or 2.0mm. (14ga.) steel sheet.

Maximum Frame Size:

3650x3048mm. or 3048x3650mm. for masonry wall installations and

3650x3048mm. for dry wall installations.

Maximum Door Opening Size:

1220x2438mm. for Single,

2438x2438mm. for Pair.

Jamb Depth:

120mm. min. thru 323mm. max.

(4³/₄" thru 12³/₄"")

Maximum Throat Opening:

114mm. for masonry wall; 92mm. for dry wall.

PRODUCT RANGE**HOLLOW METAL DOORS AND FRAMES (HMD):**

SR.No.	SERIES	PRODUCT
1	HMD	Steel Doors Non Fire Rated
2	HMD (FR)	Steel Doors Fire Rated
3	HMD AC	Sound Proof (Acoustic) Doors and Frames
4	HMD BU	Bullet Proof Doors and Frames
5	HMD XR	X-ray Proof Doors and Frames
6	HMD GA	Gas Tight Doors and Frames (Air Tight)
7	HMD TR	Transom and Sidelite Frames
8	HMD DE	Detention (Cell Doors) Doors and Frames
9	HMD EM	Embossed Steel Doors and Frames
10	HMD DU	Dutch Doors and Frames
11	HMD AC	Access Doors and Frames
12	HMDWI	Window Frames and security screens.
13	HMD PR	Prepainted Doors and Frames (Low Cost Doors)
14	HMD SS	Stainless Steel Doors and Frames
15	HMD TO	Toilet Partitions
16	HMD SE	Seamless Doors and Frames
17	HMD FO	Folding Doors

SPECIAL USAGE DOORS (SUD):

SR.No.	PRODUCT
1	Security Doors and Frames
2	Blast Proof Doors and Frames (Blast Resistance)
3	Sliding Doors
4	Sliding Gates
5	Oversize (Panelized Doors) with Pass Doors
6	Security Wall System and Ceilings (Metal Partitions)
7	Fire Rated Sliding Doors
8	Hanger Doors
9	Fiberglass Doors and Frames (Corrosion Resistance Doors)
10	Roof Hatches

The unexposed face of the doorsets to fire after 120 minutes of testing



The exposed face of the doorsets to fire immediately after testing



Picture of Advance Metal sample doors tested in a private lab for pre-assessment and pre-qualification procedures.

DOOR HANDING CHART

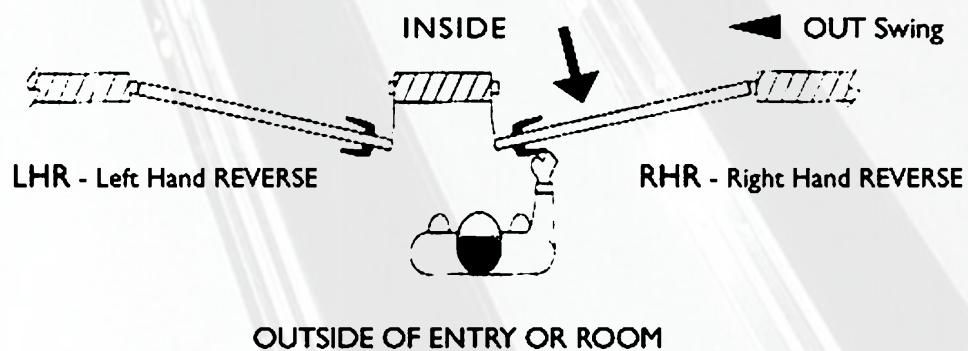
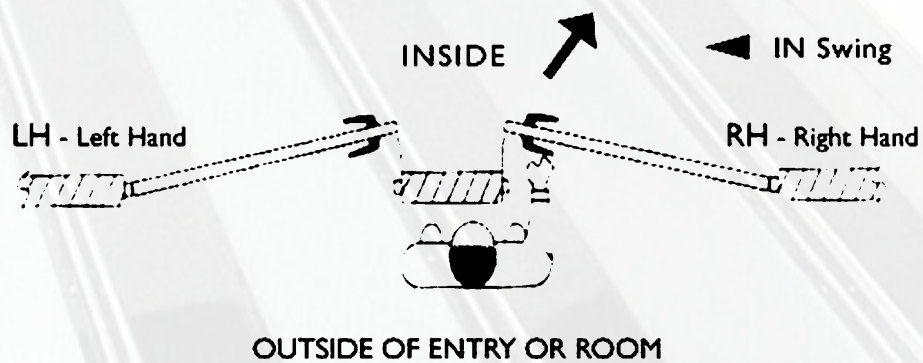

THE HANDING OF THE DOOR IS ALWAYS DETERMINED FROM THE OUTSIDE

HERE ARE A FEW RULES TO FOLLOW

- The outside of the exterior door is the street or entrance side
- The outside of a room door is the hall side
- The outside of a closet door is the room or hall side

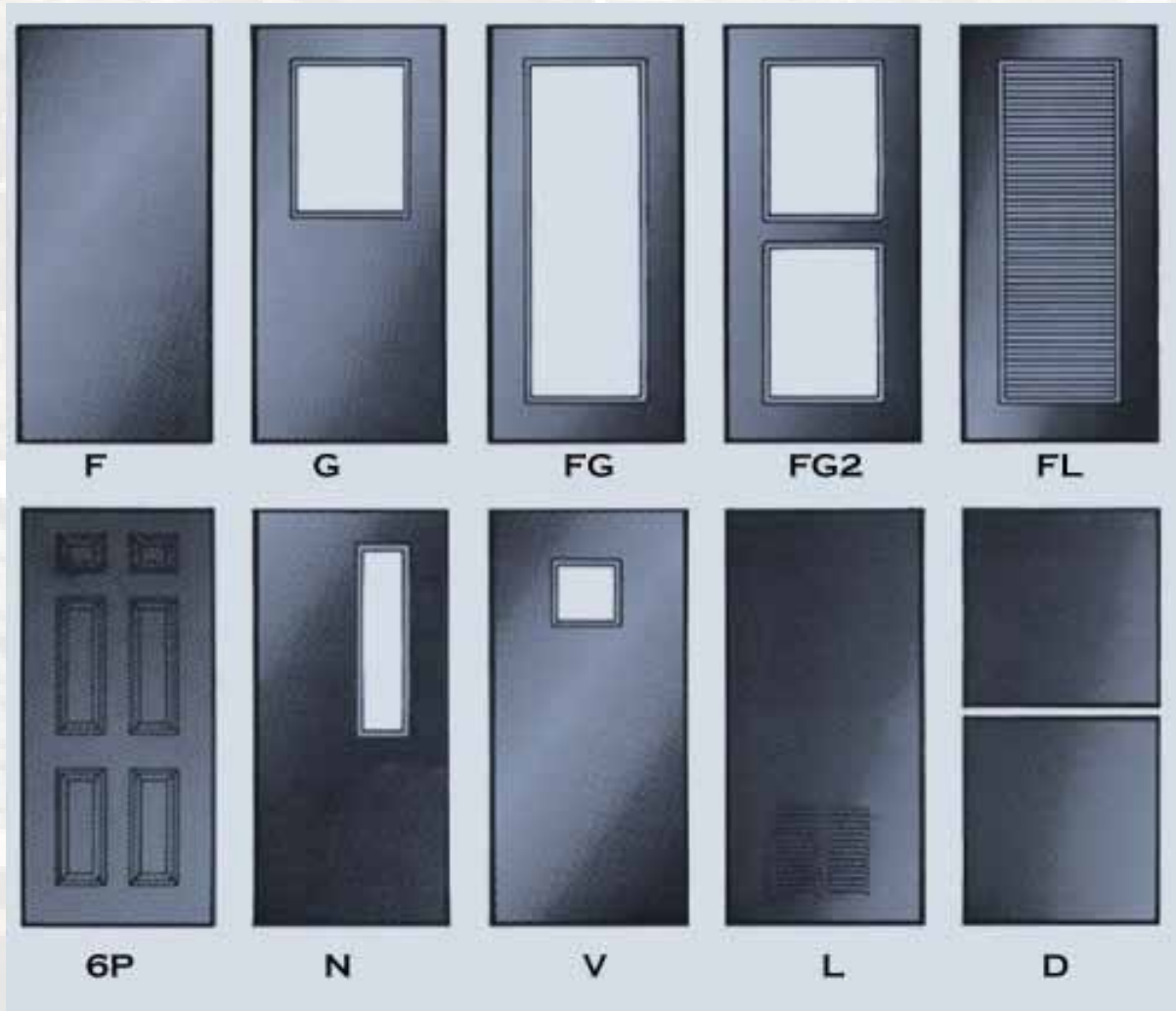

ادفانس للصناعات المعدنية ذ.م.م.

ADVANCE METAL INDUSTRIES L.L.C.

P.O.Box: 9159, Tel.: 06-7436900 / 06-7439600,

Fax: 06-7436700, Ajman - U.A.E.

E-mail: admetal@airmaster.ae

www.admetal.ae

LOCATION MAP

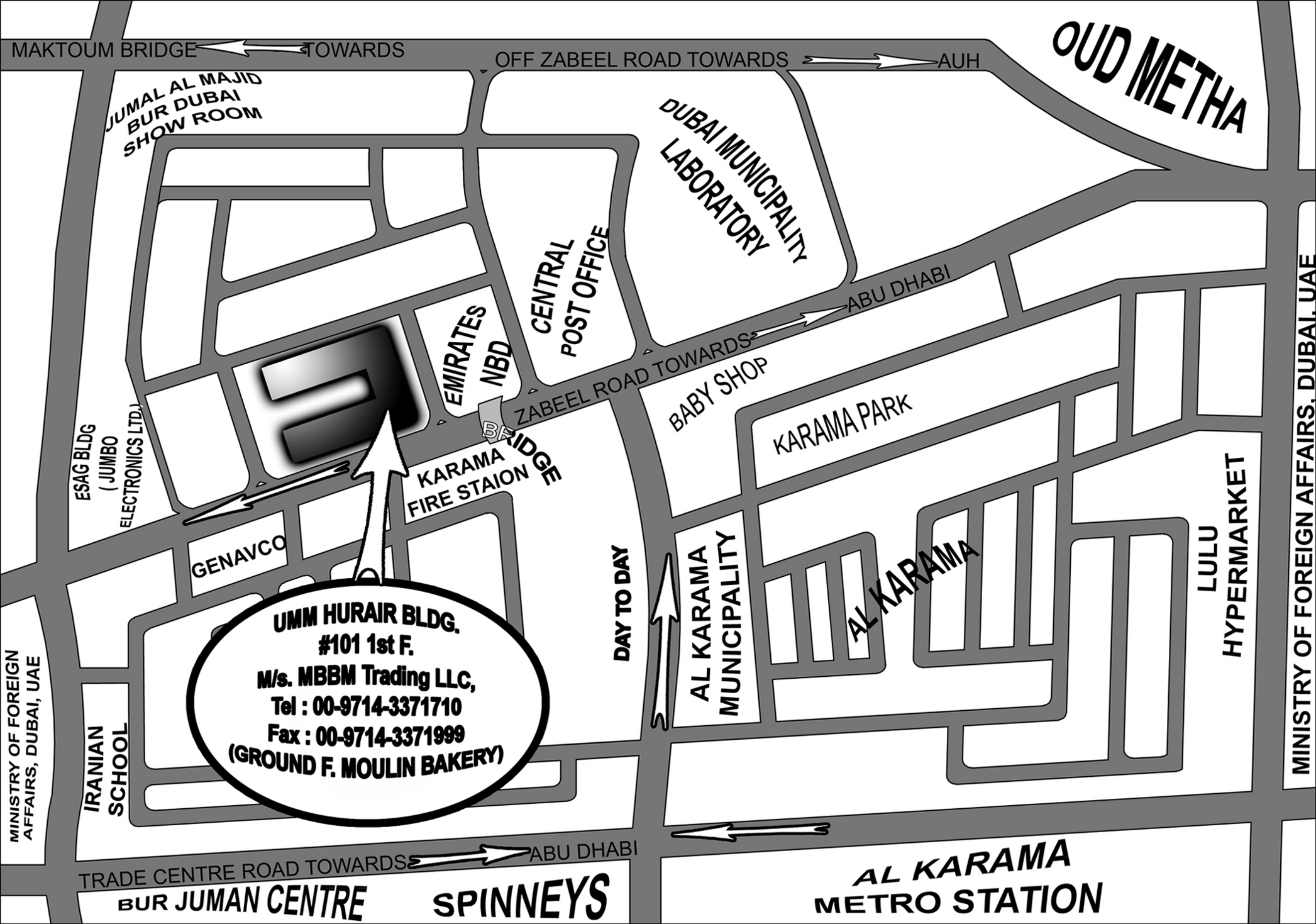

UMM HURAIR BLDG.
#101 1st F.
M/s. MBBM Trading LLC,
Tel : 00-9714-3371710
Fax : 00-9714-3371999
(GROUND F. MOULIN BAKERY)