

阿尔法船舶制造（舟山）有限公司

ALPHA BOAT MANUFACTURING (ZHOU SHAN ) CO., LTD.



2011.8.

# Alpha Group

- An international group which focuses on the yacht industry, and aims to build the yacht industrial chain.
- Covers the field of yacht manufacturing, yacht maintenance, yacht club, yacht vacation village, yacht driving training, yacht rental and yacht tourism.
- The only one company that has a complete yacht industrial chain in China and also the first one to create a yacht chain business model in China.
- Two companies:
  - **Alpha Boat Manufacturing (Zhoushan) Co., Ltd.**
  - **Zhoushan Alpha Yacht Club Development Co., Ltd.**

# Alpha Boat Manufacturing (Zhoushan) Co., Ltd.

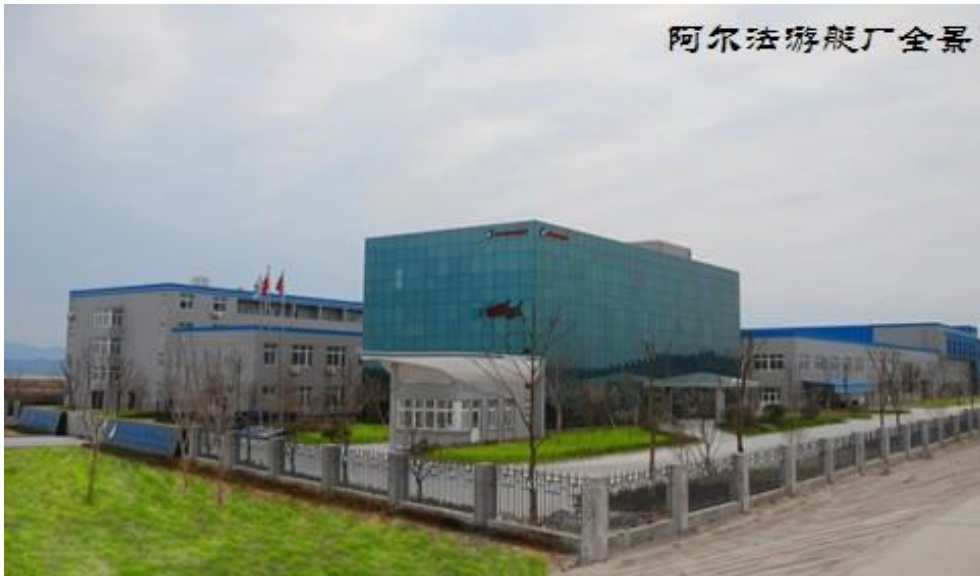

- Founded in June 2005.
- Wholly foreign fund.
- Invested by a Norwegian company previously.

- Located in the yacht industry zone, Zhujiajian of Zhoushan archipelagos.
- Occupies 40,000 square meters (Construction area: 20,000 square meters).
- Integrates the functions and services of yacht R&D, manufacturing, maintenance, sales and after-sales.

# Alpha Boat Manufacturing (Zhoushan) Co., Ltd.

## Boat series

- RIB series boats
  - RIB600、RIB700、RIB32、RIB36
- Luxury FRP yacht
  - Alpha50
  - Alpha75
- Leisure wooden boat, sailing boat and fishing boat.

High speed, Stability, Clean energy & Power saving.

Approved by DNV with CE certification.



### RIB600 Specifications:

LOA:	6.2M
Beam:	2.4M
Draft:	0.32M
Fuel capacity:	65/100L
Max load capacity:	1000KG
Recommended engine:	60-100hp
Top Speed :	47knots



### RIB700 Specifications:

LOA:	7.0M
Beam:	2.5M
Draft:	0.33M
Fuel capacity:	65/100L
Max load capacity:	1200KG
Recommended engine:	80-115hp
Top Speed :	49knots

**Adopting the ultra-low center of gravity design, RIB600/700 has an amazing speed, stable manipulation, superexcellent performance and favorable price, it's your ideal choice for sea sports and leisure.**



### **RIB32 Specifications:**

<b>LOA:</b>	9.97M
<b>Beam:</b>	2.97M
<b>Draft:</b>	0.48M
<b>Fuel capacity:</b>	300L
<b>Max load capacity:</b>	1340KG
<b>Recommended engine:</b>	Yanmar 315hp
<b>Top Speed :</b>	45knots

**The jockey-seat will lead you freely driving on the sea, the spacious deck with sun bathing mattress ensuring enjoyment for sun lovers.**





### RIB36 Specifications:

LOA:	11.7M
Beam:	3.6M
Draft:	0.7M
Fuel capacity:	500L
Water capacity:	100L
Recommended engine:	Twin Yanmar 315hp / Bravo 1
Top Speed :	50knots

**The largest, most advanced and luxurious inflatable boat in the world. Fast, stable, efficient characteristics, as well as elegant performance must become the first choice of your business needs, or the SUV of your water sports.**

## RIB36-Explorer A



## RIB36-Explorer B







### **ALPHA50 Specification:**

<b>LOA:</b>	15.24M
<b>Beam:</b>	4.46M
<b>Draft:</b>	1.22M
<b>Fuel capacity:</b>	1600L
<b>Water capacity:</b>	500L
<b>Displacement:</b>	14-15T
<b>Recommended engine:</b>	Twin VOLVO PENTA D9-575
<b>Design Speed:</b>	24-32knots
<b>Cruising Range:</b>	450 nautical miles

**You can begin your luxurious life at sea from ALPHA50. Her unique design contains all the imaginable exquisite and luxury, giving the unparalleled spiritual enjoyment and freely sea traveling choice to you.**

# ALPHA50 Interior Photos







# ALPHABOAT *Alpha 75*

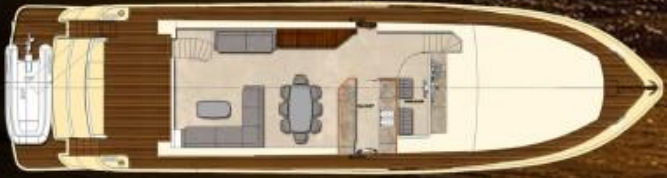



### **Wooden Boat Specification:**

<b>LOA:</b>	6.96M
<b>Beam:</b>	2.05M
<b>Draft:</b>	0.55M
<b>Displacement:</b>	650KG
<b>Engine:</b>	Electrical or Diesel engine
<b>Optimum economy Speed:</b>	7-10 knots

**Having a history of more than half a century, the classic Norwegian wooden boat develops from Northern Europe Viking ship, which has a strong Nordic style. Adopting environmental electric motor propulsion shows that the boat is also integrated into the low-carbon and energy-saving trend.**



# Alpha Boat Manufacturing (Zhoushan) Co., Ltd.

## Workshop Facilities

- Modern factory and advanced facilities.
- Designs, moulds and skills from Sweden, Norway, UK, Italy and Australia.
- 5 workshops including FRP, Carpentry, Painting, Pontoon installation and Assembly.
- 50 production workers, 10 engineers and technicians.

# Zhoushan Alpha Yacht Club Development Co., Ltd.



- Owns Putuo International Yacht Club, five-star hotel and luxury seascape view villas.
- Putuo International Yacht Club---the first and unique large-scale sea yacht club of the Yangtze River Delta area.

# Zhoushan Alpha Yacht Club Development Co., Ltd.

- Occupies sea area of 50,000 square meters, with coastline of 800 meters.
- the marina has 108 berths, the biggest one can berth 120 feet long yacht.
- 54 seascape view villas.
- one luxury yacht club of 2,000 square meters building area.
- one five-star hotel covers 35,000 square meters.

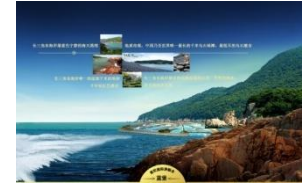

# The Advantages of Zhoushan to Develop Tourism and Yacht Industry

## ● Geographic Location Advantage

- Zhoushan is located in the **middle** of China mainland's coastline.
- It perches on the **Yangtze River Delta**, which is the **richest** area of China, including cities like **Shanghai, Hangzhou & Ningbo**.



## ● Resources Advantage

- More than **280km** deep coastline, ranks number 1 of China.
- **1390** islands of different sizes, occupies 20% of all Chinese islands
- Many beautiful **landscapes for tourism**, for example Buddhist's heaven - **Mount Putuo Island**, the easternmost island of China – **Dongji Island**, national ecological island – **Zhujiajian Island**, martial art legend island – **Taohua island**, and the relaxing fishing island – **Baisha Island**.



## ● Policy Advantage

- **The fourth New District of China**---positions to be 1) comprehensive bonded port area, 2) the exchange center of China's bulk goods, 3) international shipping and tourism centers, and 4) pilot area of tax incentives.



# Yacht Industry in China

- **China is rich of water resources.**
  - **18 thousand km** of coastline, more than **6,500** islands and **90,000** lakes, as well as the **four** river systems.
- **Strong yacht manufacturing and sales.**
  - The current yacht manufacturing enterprises in China mainland reaches **325**.
  - The export amount of four major categories of yacht in 2010 is **2,028,700**, with total value of **204.2 million USD dollar**.
- **Yacht accessory industries are developing rapidly.**
  - From molding, instrumentation, hardware accessories, FRP material, wood, glass and metal materials are **all available** on the Chinese market.



# Yacht Industry in China

- **Yacht supporting infrastructure is accelerating construction.**
  - Currently there are **26** yacht clubs, **26** under construction, and **40-50** preparing to be built.
- **Chinese government has issued a series of support policy related to yacht industry.**
  - It positions the yacht activity being **public sports and leisure activities**.
  - It **deregulates** the yacht cross-regional sailing and **simplifies** the approval procedures and permit conditions.
  - It **issues the standards** of yacht safety regulation, etc...
- **The consumption power of Chinese along with their consumption concept, content and forms is changing.**
  - In 2010, Chinese luxury market has reached **10.7 billion dollars**, which occupies **4.21%** of the world market.

## 游，是一種境界

*Travel is a sort of ambition*

就遊交錯外的一點浪由

環繞光華中的一顆界心

青山碧海間的一塊飄逸

.....

對於一個成功者來說，遊，是一種境界

是跳出眼前世界的一份那達的心境

# THANK YOU!

